

# MFT85 160R



\_\_\_\_\_ (Original instructions) **User's Manual**



Read the instructions in the User's Manual.  
Familiarise yourself with the machine's controls and operation.

**EN**

\_\_\_\_\_ (Originalanleitung) **Betriebsanleitung**



Bitte lesen Sie die in dieser Anleitung enthaltenen Anweisungen.  
Machen Sie sich mit der Funktionsweise und der Bedienung der Maschine vertraut.

**DE**

\_\_\_\_\_ (Notice originale) **Manuel d'utilisation**



Lire les instructions du manuel utilisateur.  
Se familiariser avec le fonctionnement et les commandes de la machine.

**FR**

\_\_\_\_\_ (Manual original) **Manual de uso**



Leer las instrucciones del manual de usuario.  
Familiarizarse con el funcionamiento y los mandos de la máquina.

**ES**

\_\_\_\_\_ (Manuale originale) **Manuale d'uso**



Leggere le istruzioni riportate nel manuale d'uso.  
Familiarizzarsi con il funzionamento e con i comandi della macchina.

**IT**

\_\_\_\_\_ (Oorspronkelijke handleiding) **Gebruikshandleiding**



De instructies vermeld in de gebruikshandleiding lezen.  
Zich vertrouwd maken met de werking en de bediening van de machine.

**NL**

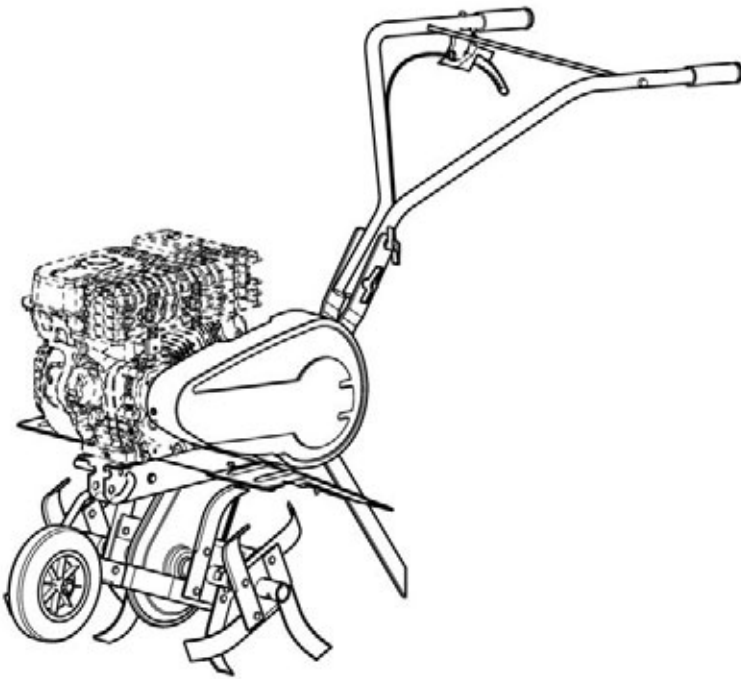

# McCULLOCH®

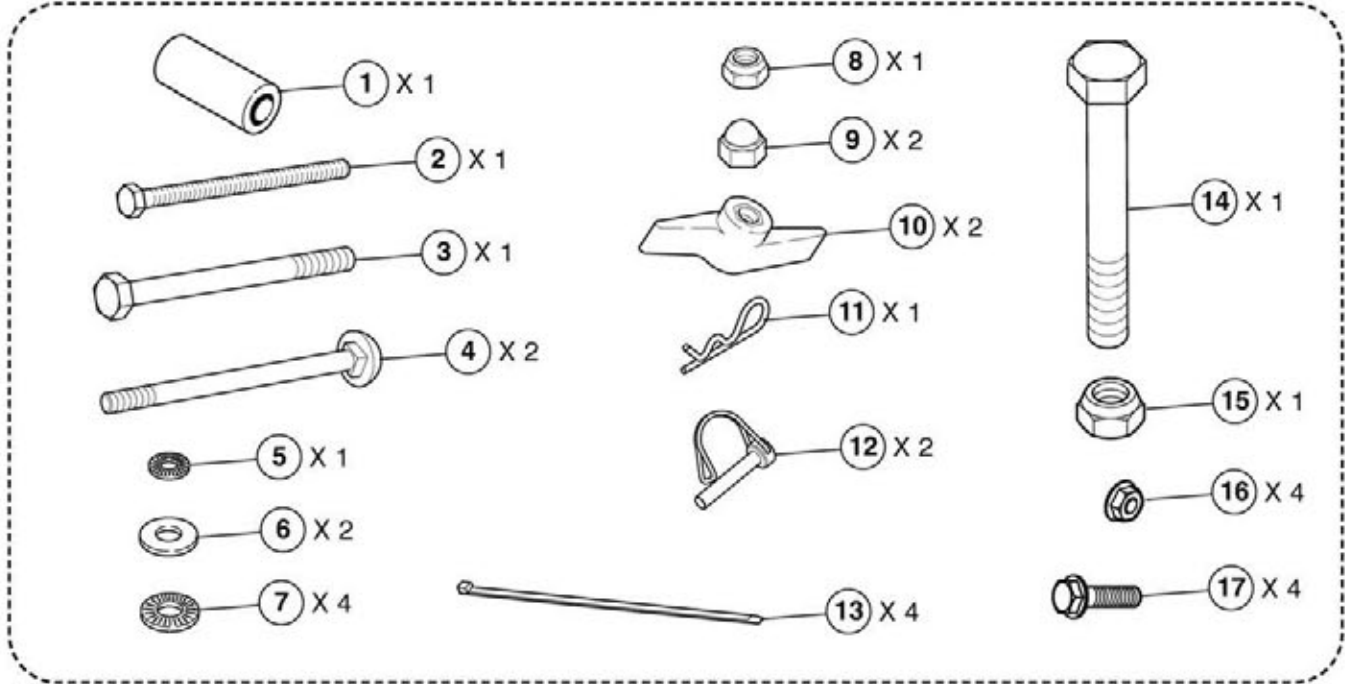
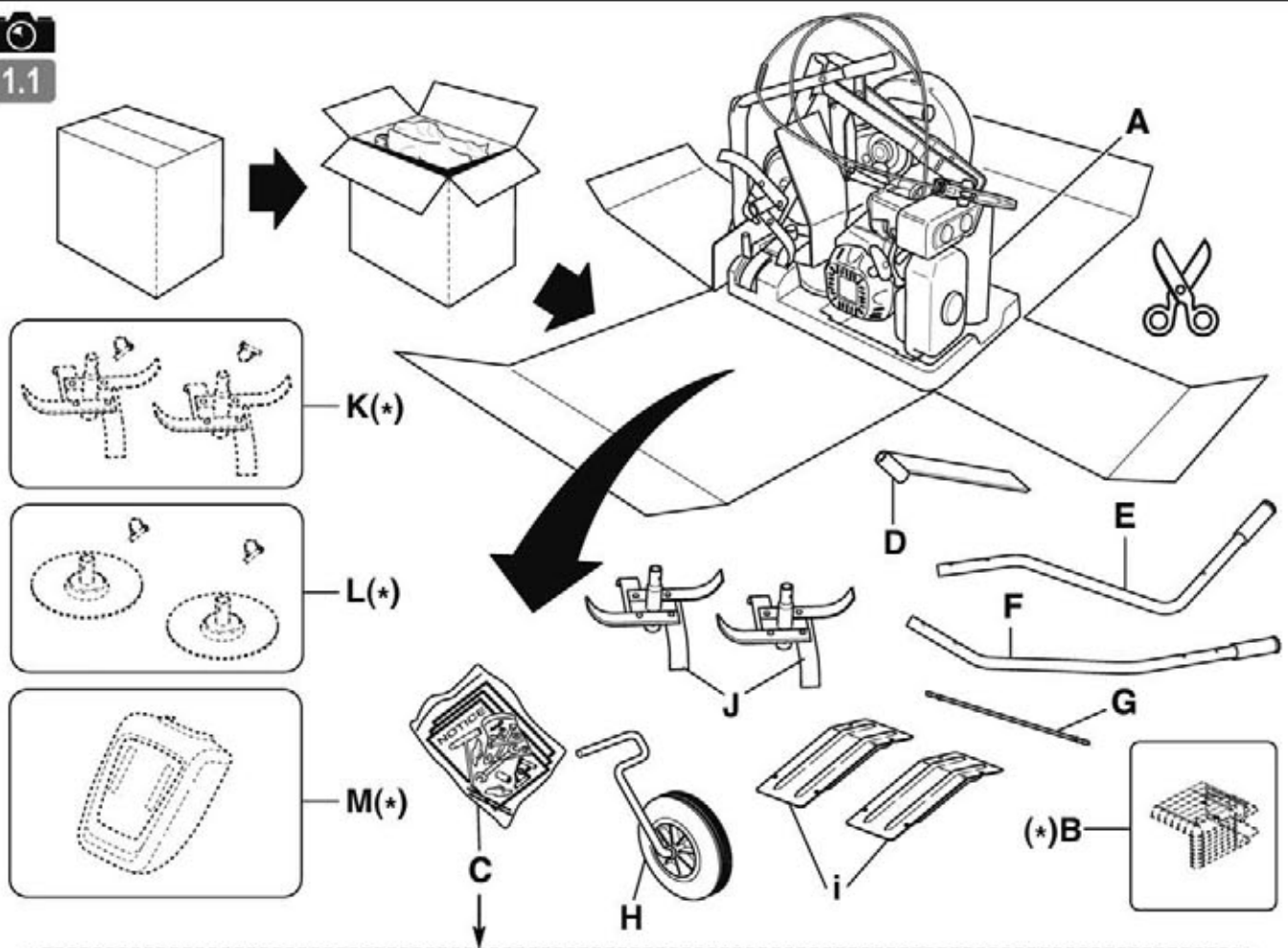

→ 10 - 13 - 19 - 21 - 22 - 23

(\*) : FR : (suivant version) - EN : (depending on the version) - DE : (je nach Ausführungsvariante) - BG : (според варианта)  
 HR : (ovisno o verziji) - DA : (Afhængigt af version) - ES : (Según versión) - ET : (järgmine versioon) - FI : (mallista riippuen)  
 EL : (ανάλογα με το μοντέλο) - HU : (verziótól függően) - IT : (A seconda del modello) - LV : (atkarībā no versijas)  
 LT : (priklausomai nuo versijos) - NL : (Naar gelang model) - NO : (Avhengig av versjon) - PL : (Zależnie od wersji)  
 PT : (Consoante versão) - RO : (În funcție de versiune) - TR : (versiyona göre) - SK : (v závislosti od verzie) - SL : (odvisno od verzije)  
 SV : (beroende på version) - CZ : (v závislosti na provedení) - UK : (в залежності від версії) - RU : (В зависимости от модификации)

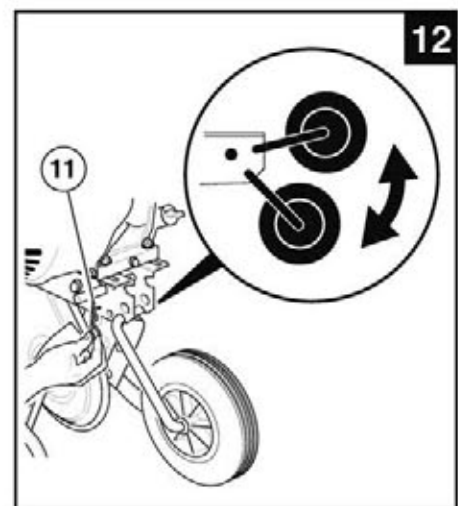
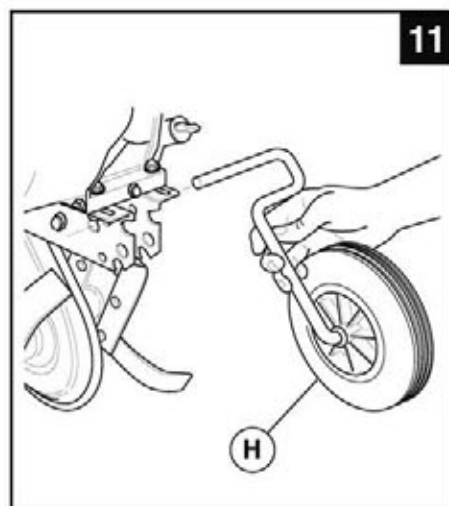
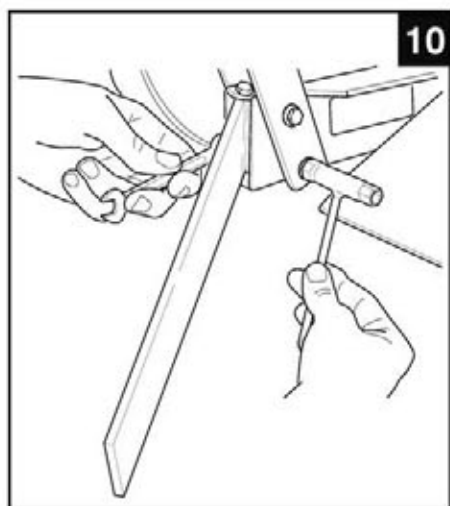
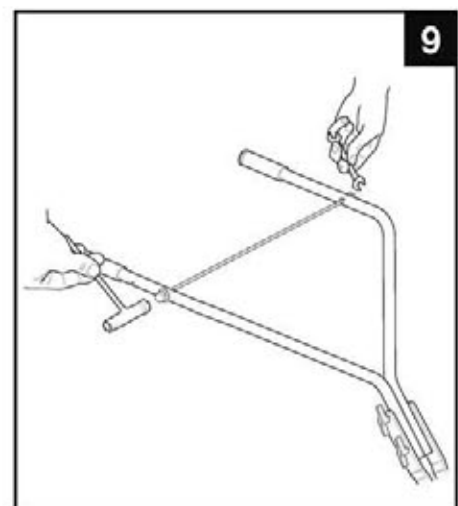
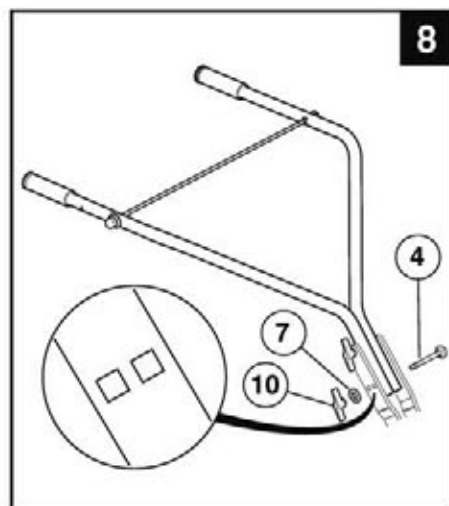
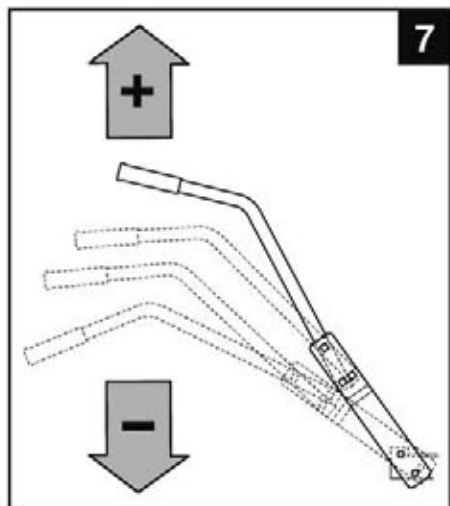
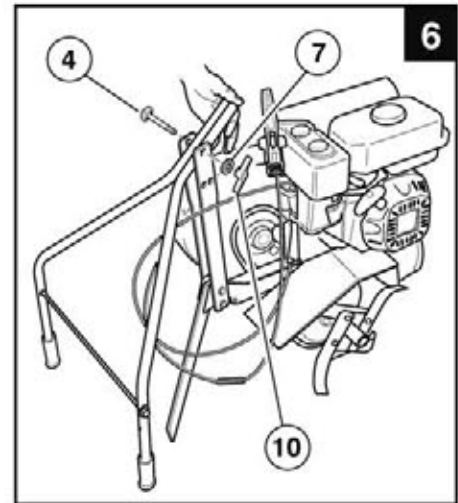
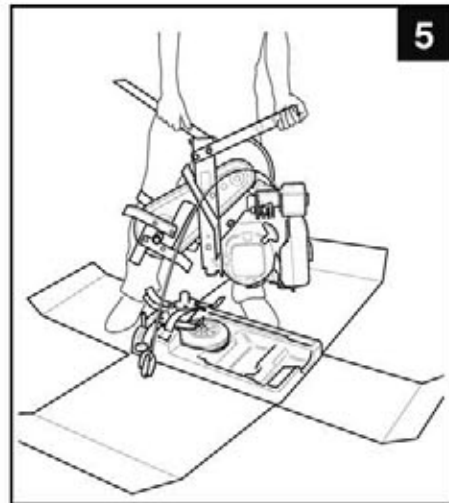
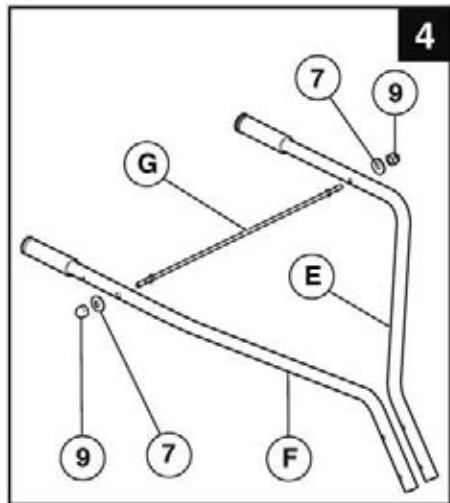
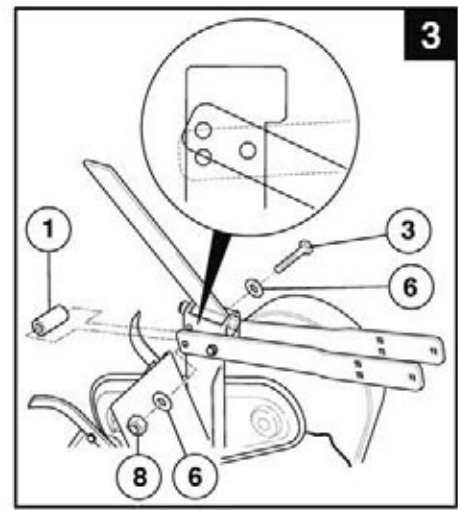
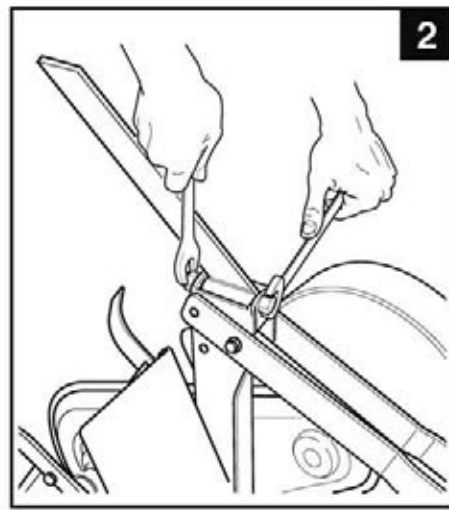
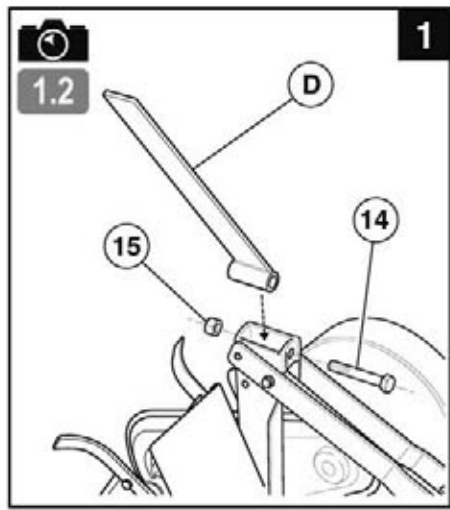

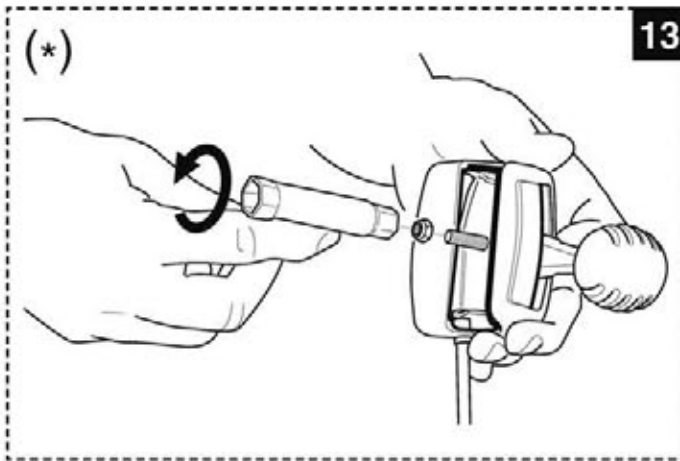

13

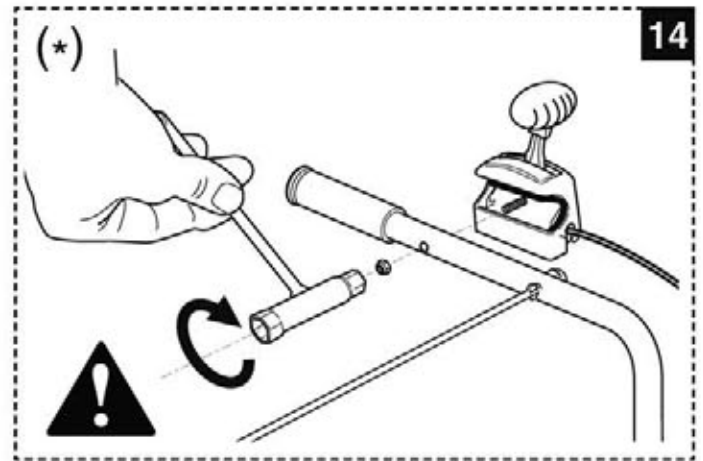

14

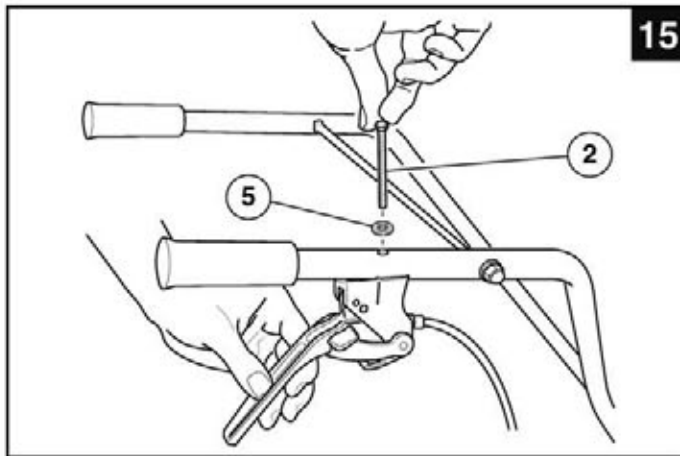

15

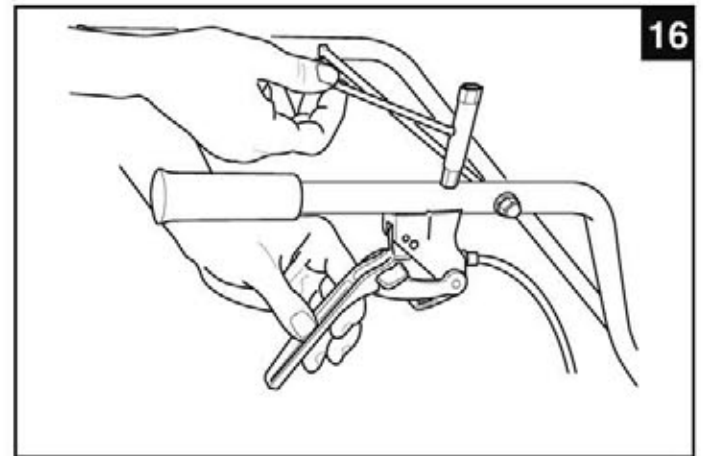

16

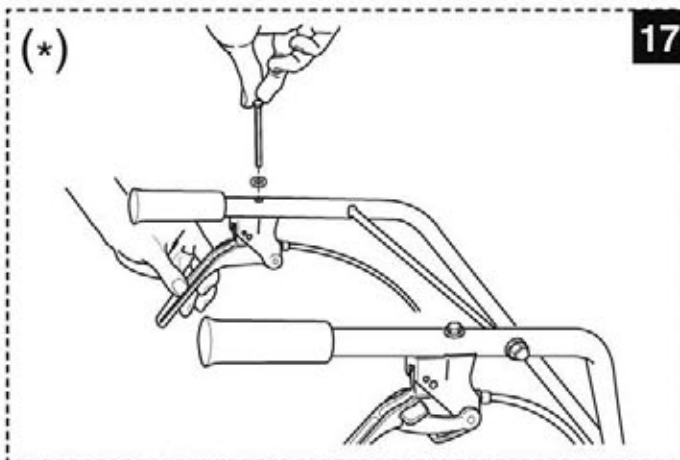

17

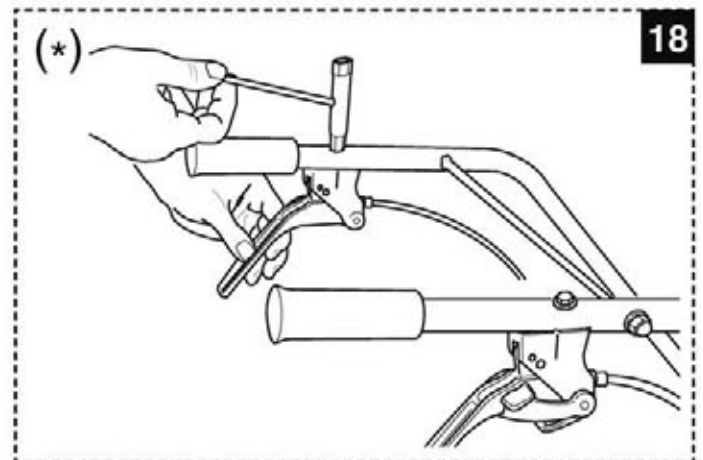

18

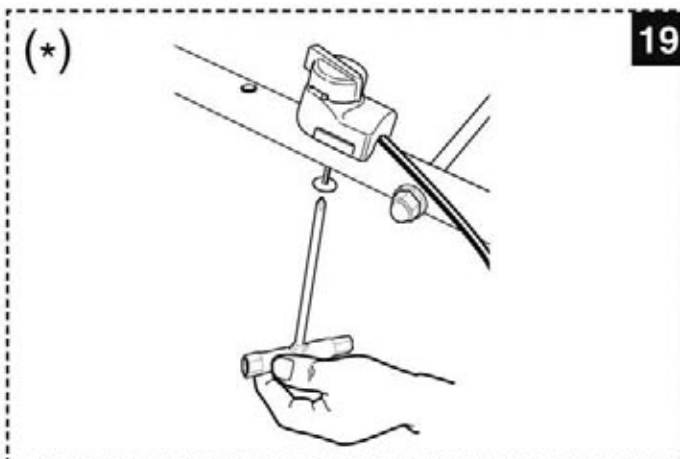

19

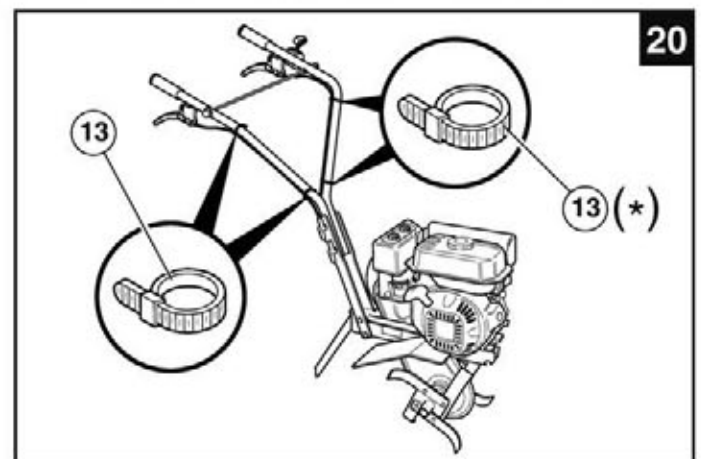

20

(-): FR : (suivant version) - EN : (depending on the version) - DE : (je nach Ausführungsvariante) - BG : (според варианта)  
 HR : (ovisno o verziji) - DA : (Afhængigt af version) - ES : (Según versión) - ET : (järgmine versioon) - FI : (mallista riippuen)  
 EL : (ανάλογα με το μοντέλο) - HU : (verziótól függően) - IT : (A seconda del modello) - LV : (atkarībā no versijas)  
 LT : (priklausomai nuo versijos) - NL : (Naar gelang model) - NO : (Avhengig av versjon) - PL : (Zależnie od wersji)  
 PT : (Consoante versão) - RO : (În funcție de versiune) - TR : (versiyona göre) - SK : (v závislosti od verzie) - SL : (odvisno od verzije)  
 SV : (beroende på version) - CZ : (v závislosti na provedení) - UK : (в залежності від версії) - RU : (В зависимости от модификации)

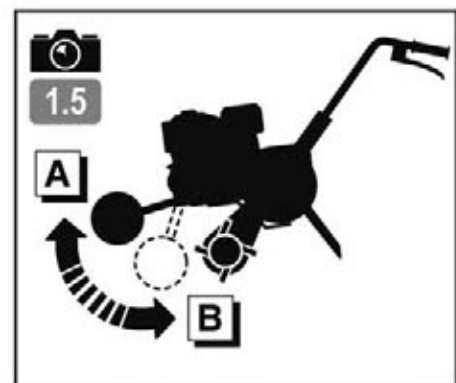
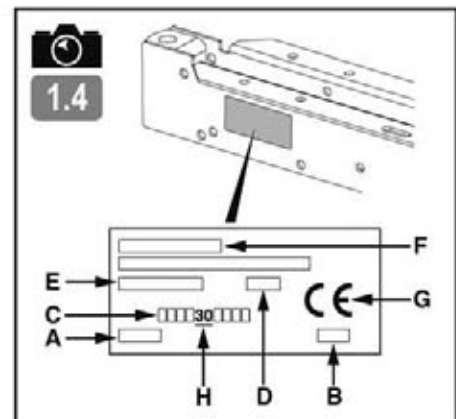
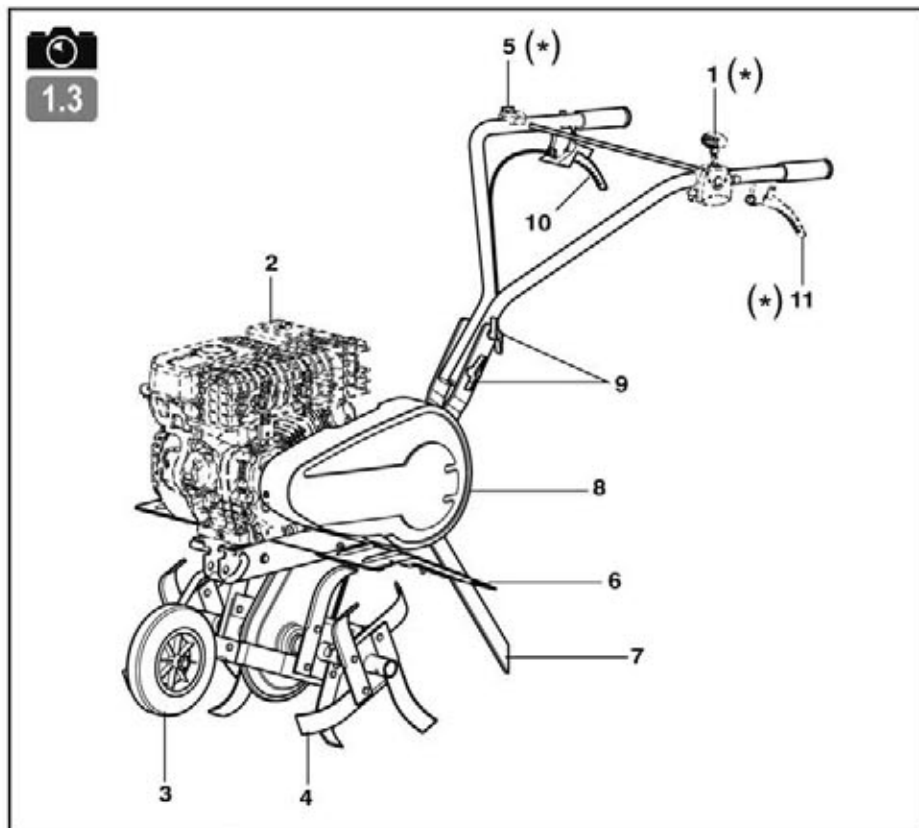
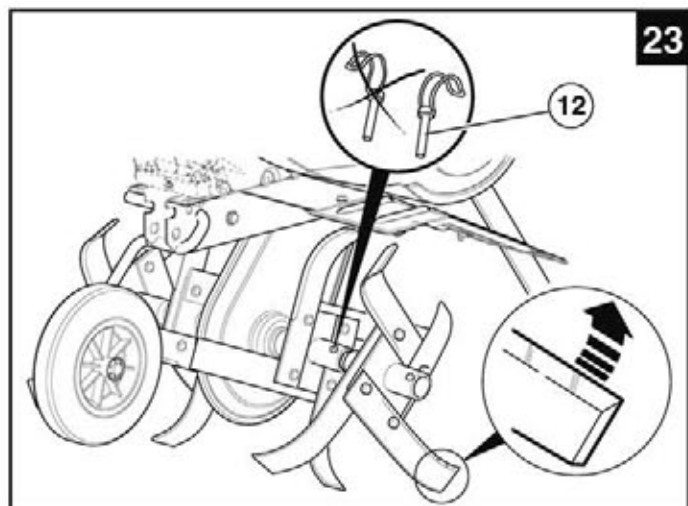
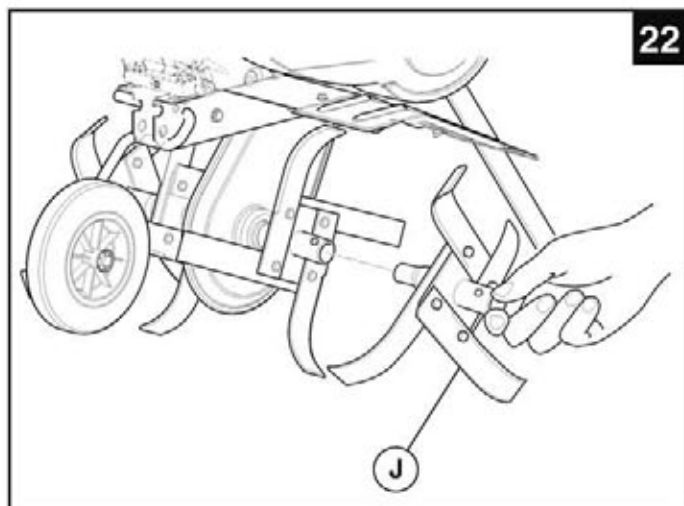
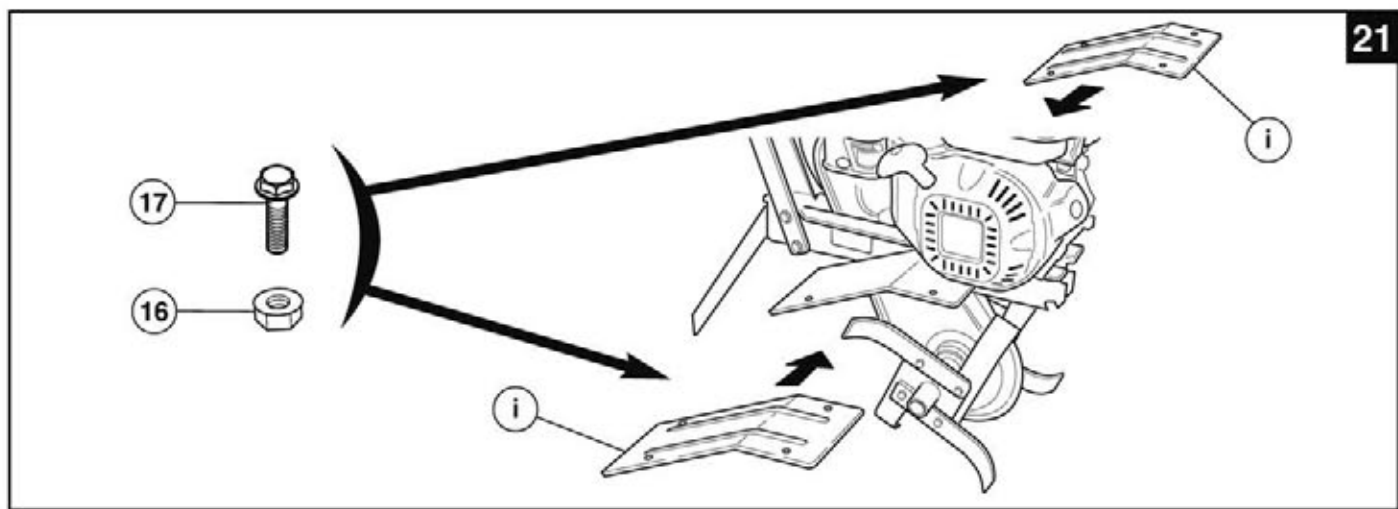

(\*): FR : (suivant version) - EN : (depending on the version) - DE : (je nach Ausführungsvariante) - BG : (според варианта)  
 HR : (ovisno o verziji) - DA : (Afhængigt af version) - ES : (Según versión) - ET : (järgmine versioon) - FI : (mallista riippuen)  
 EL : (ανάλογα με το μοντέλο) - HU : (verziótól függően) - IT : (A seconda del modello) - LV : (atkarībā no versijas)  
 LT : (priklausomai nuo versijos) - NL : (Naar gelang model) - NO : (Avhengig av versjon) - PL : (Zależnie od wersji)  
 PT : (Consoante versão) - RO : (În funcție de versiune) - TR : (versiyona göre) - SK : (v závislosti od verzie) - SL : (odvisno od verzije)  
 SV : (beroende på version) - CZ : (v závislosti na provedení) - UK : (в залежності від версії) - RU : (В зависимости от модификации)

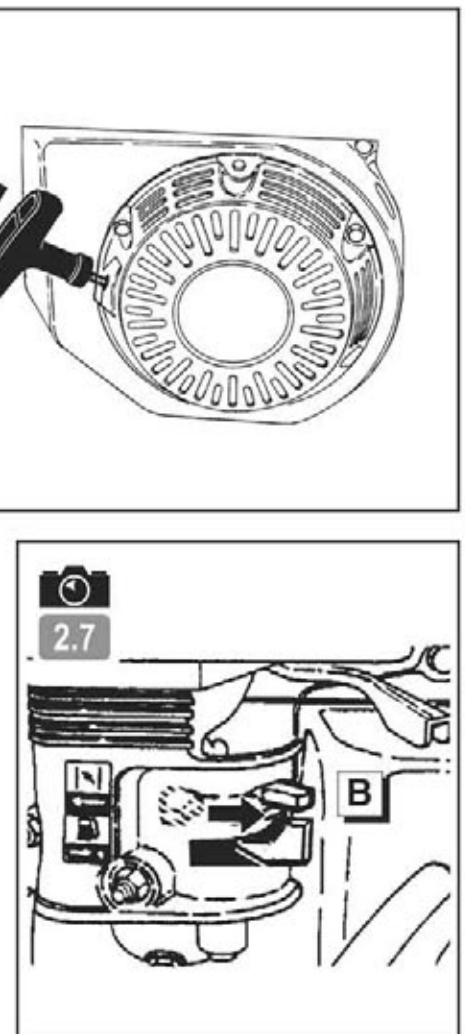
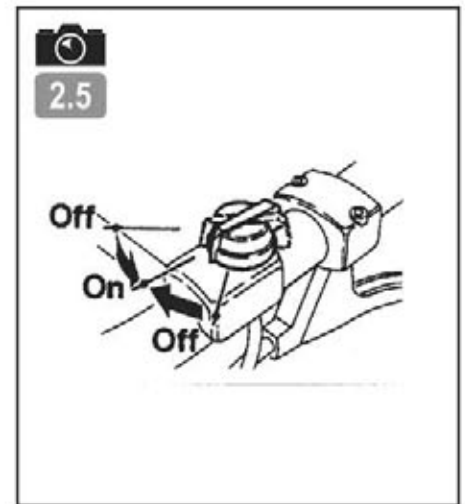
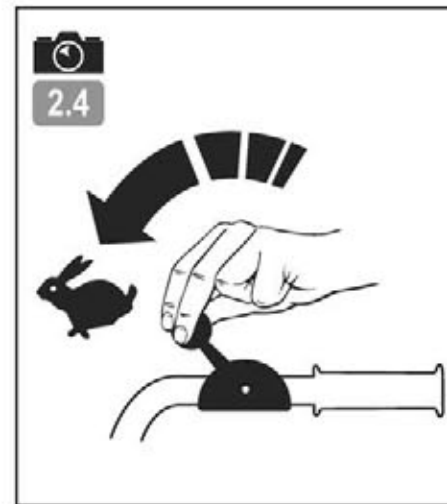
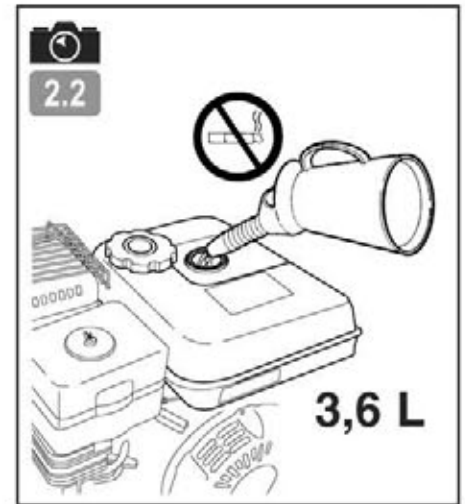
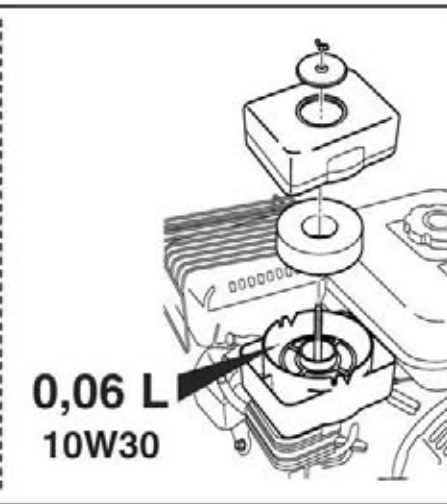
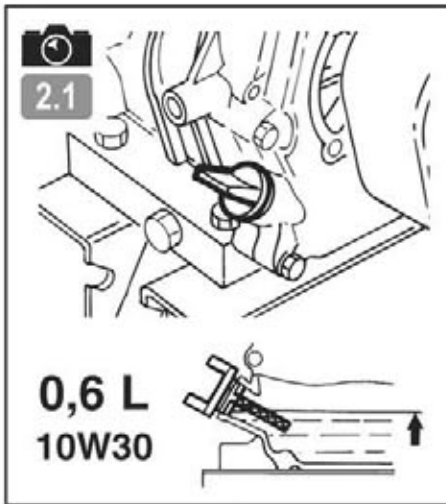

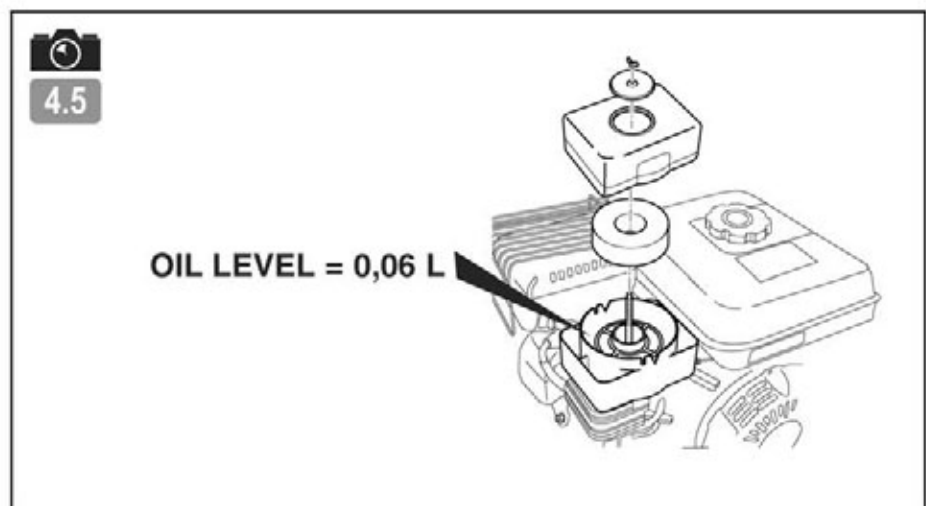
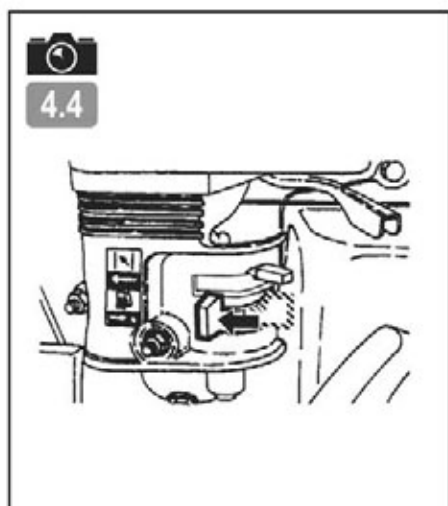
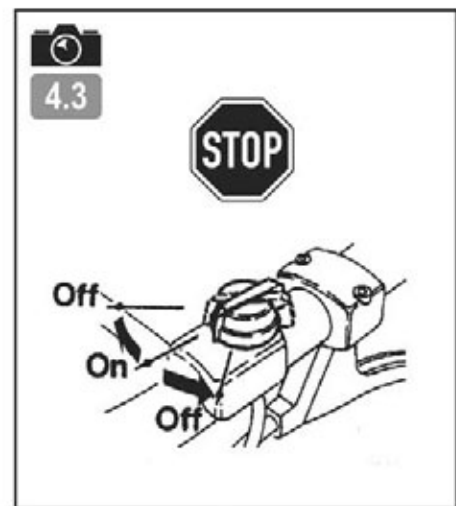
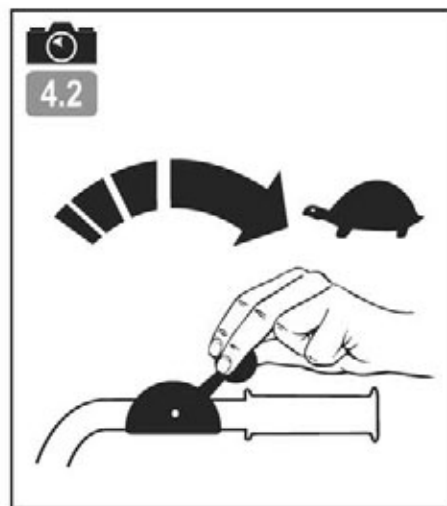
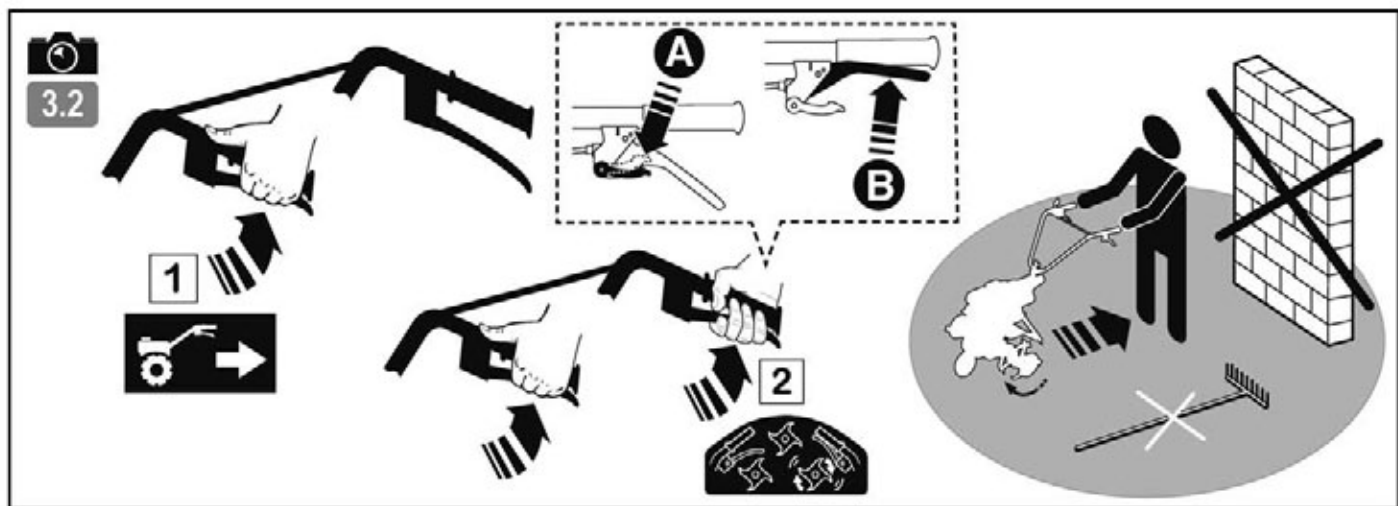
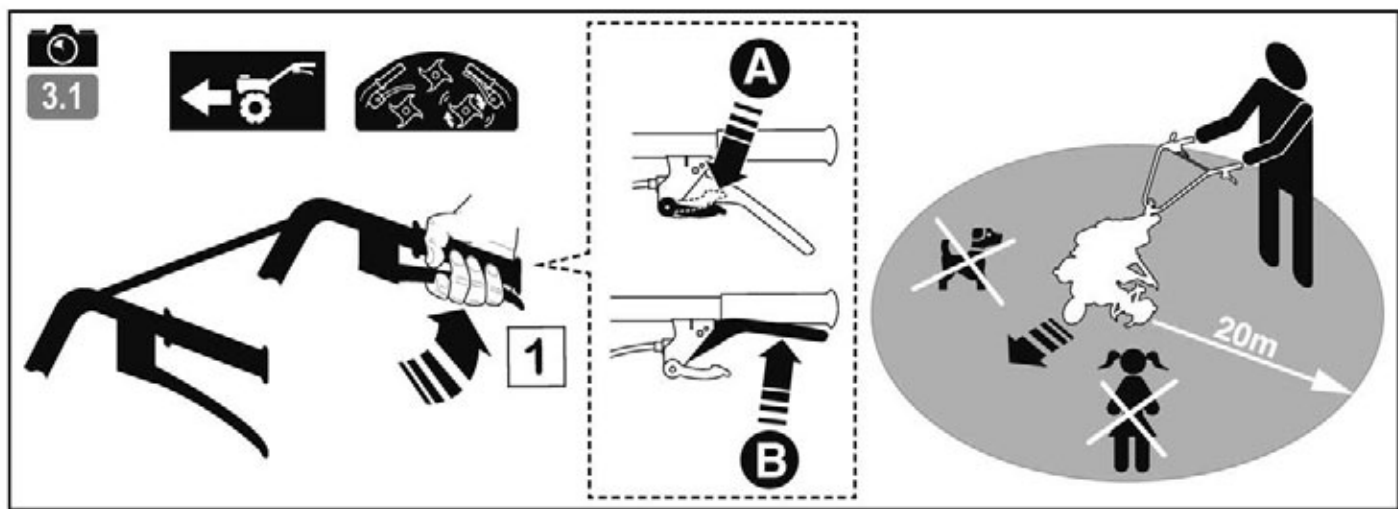

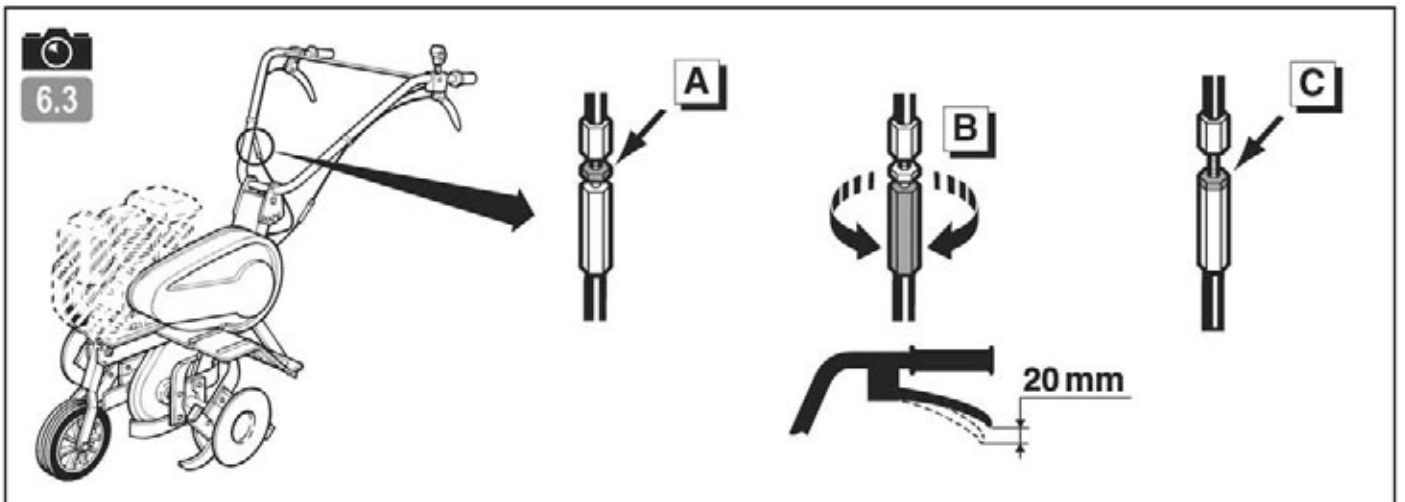
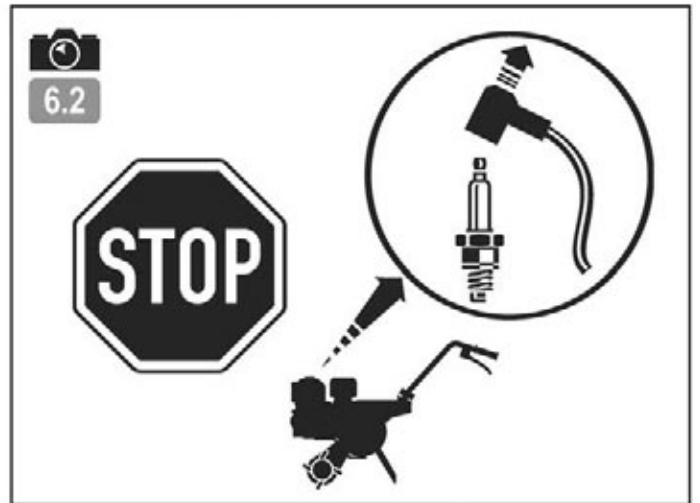
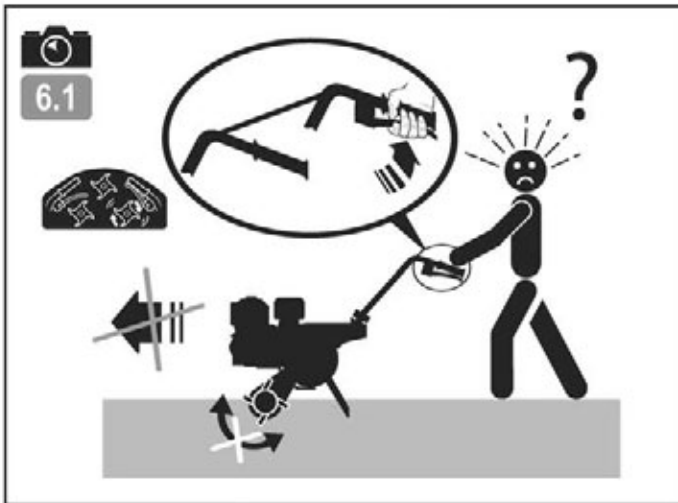
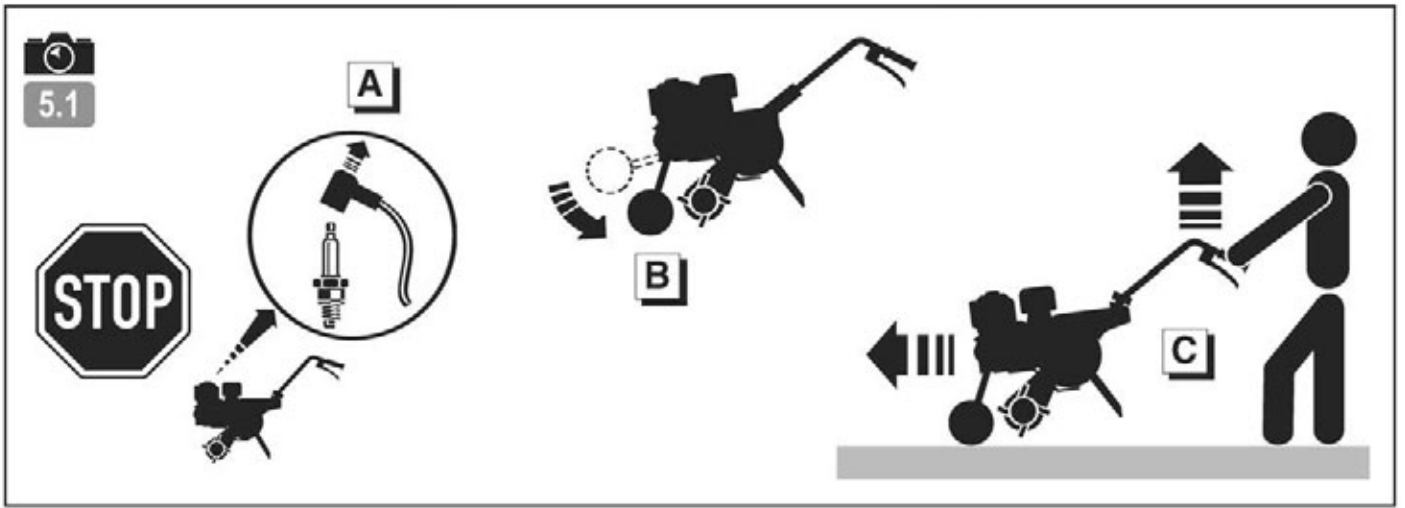



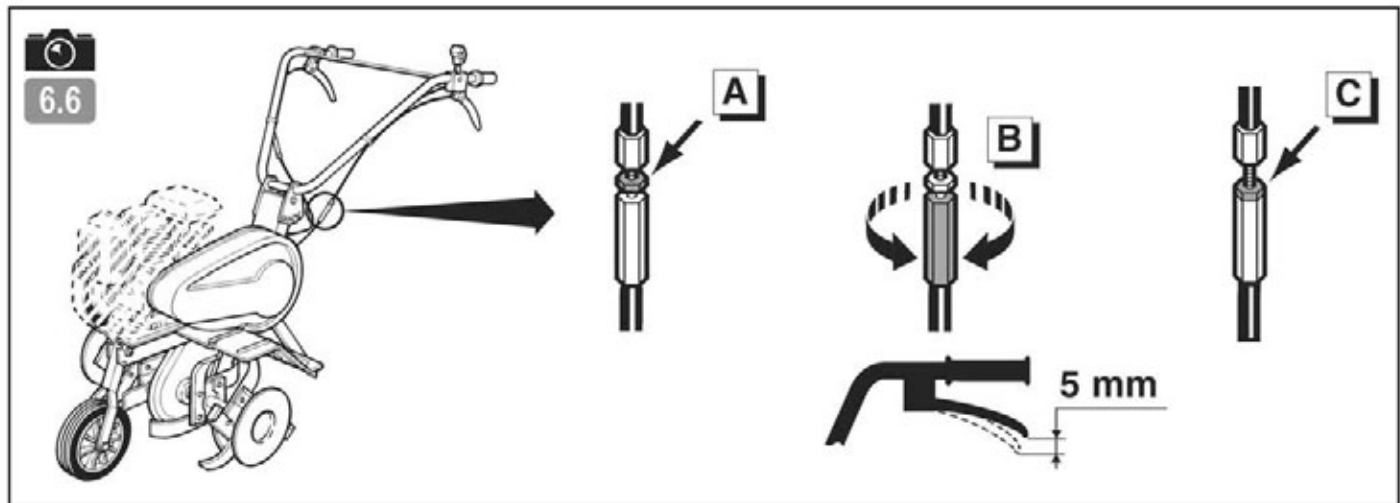
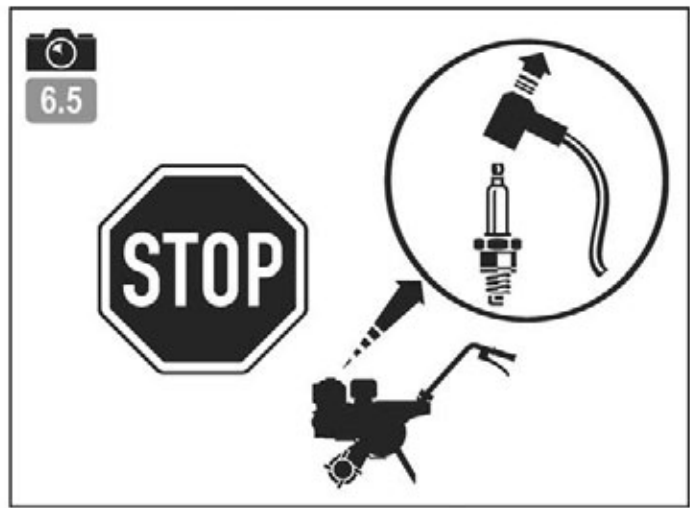
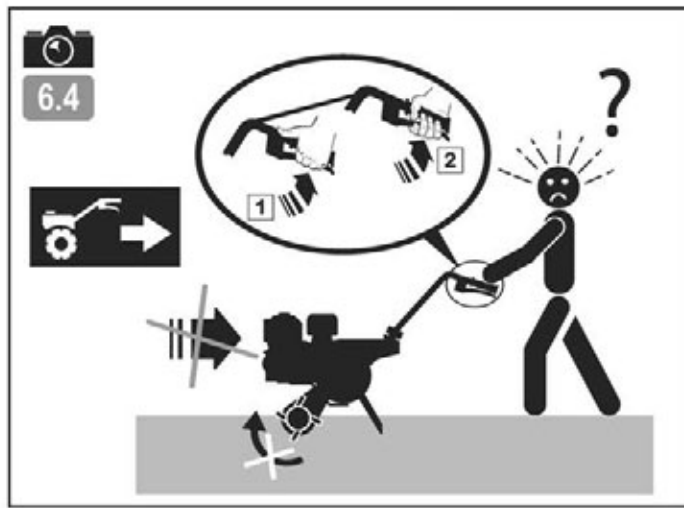

# SAFETY PRECAUTIONS

Pay particular care to the sections marked as follows:

EN



**DANGER** : This indicates a strong likelihood of serious or even fatal injury if the instructions are not followed.

DE

**WARNING** : This indicates a risk of injury or damage to the equipment if the instructions are not followed.

FR

**NOTE** : This indicates useful information.

ES



This symbol reminds you to take care with certain operations.

IT

If you have any problems or questions about the cultivator, please contact your approved supplier.

NL



**DANGER** : The machine is designed for safe and reliable service if used as instructed. Before using your machine, please make sure you have understood the contents of this manual. Otherwise you could be injured and your equipment could be damaged.

## Training / Information

- Familiarise yourself with the correct use and the controls before using the machine. Know how to stop the motor rapidly.
- The machine must always be used according to the recommendations given in the instruction manual.
- Remember that the user is responsible for any accidents or dangerous reactions occurring to other people or their belongings. It is his responsibility to assess the potential risks of the ground to be cleared and to take all precautions necessary to ensure it is safe, in particular on slopes and on loose, slippery or uneven ground.
- Never allow children or people unfamiliar with these instructions to use the machine. There may be local laws which set a minimum age for users.
- Never work when there are people, especially children, or animals within a radius of 20 meters of the machine; the operator must necessarily remain at the controls of the handles.
- Do not use the machine if you have been taking medicine or other substances that might slow your reactions or make you drowsy.
- Pay particular attention on hard ground, because the machine has the tendency to be much less stable than on cultivated ground.
- Always wear sturdy, non-slip footwear and tight long trousers when working. Do not use the machine in bare feet or sandals. Ear protectors are recommended.
- Use the machine for the purpose it is designed for - digging the ground. Any other use may be dangerous or cause damage to the machine.

## Preparation :

- Carefully inspect the area where the machine is to be used and remove any objects that might be projected by the machine (stones, wire, glass, metal objects ...).
- Before use, always check over the machine to ensure that the tools and deflectors are not worn or damaged. Replace any worn or damaged parts.
- Maintain the electrical cables that stop the motor in good condition so that you can be sure to turn the motor off.
- Check that no petrol or oil are leaking.
- Do not use the machine without its protective casings and ensure that all the fittings are tight.

## Use :

- Never transport people on the machine.
- Take care when starting the motor, following the manufacturer's instructions and keeping your feet away from the blade(s).
- Stop the motor when the machine is not in use.
- When holding the machine, walk don't run.
- Take great care when pulling the machine towards you or reversing the direction of rotation (if fitted).
- Keep a safe distance from the rotating blades, set by the length of the steering column.
- Do not place your hands or feet near or beneath rotating parts.
- If there is :
  - abnormal vibration,
  - a blockage,
  - a problem engaging or disengaging the clutch,
  - a collision with a foreign object,
  - deterioration of the engine halt cable (following model).
- Stop the engine immediately (if the Engine halt cable is severed, use the starter control as described in paragraph "start the engine" to stop the Engine), let the machine cool down, unplug the spark-plug lead, inspect the machine and have the necessary repairs carried out by an approved repairer before using again.
- Work only by daylight or in good artificial light.
- Do not use the machine on slopes greater than 10° (17%).
- Work across slopes, not up or down them.
- Make sure to keep your footing on sloping ground, change direction very carefully.
- Using accessories other than those recommended may make the machine dangerous and cause damage to your machine which will not be covered by your guarantee.

## Maintenance / storage

- Stop the motor and disconnect the spark plug before cleaning, inspecting, adjusting or maintaining the machine or changing the tool(s).
- Stop the motor, disconnect the spark plug and use thick gloves when changing the tool(s).

- Keep all nuts and bolts tight to ensure safe conditions of use.
- To reduce fire risk, keep the motor, the silencer and the fuel storage area free of plants, waste oil, or any other inflammable material.
- If the exhaust silencer is defective, have it replaced by an approved repairer.
- Do not mend parts; replace them by the maker's own spares.
- Replace the cutting blades in complete sets to keep them balanced
- For your own safety, do not alter the characteristics of your machine. Do not the motor speed settings and do not run the motor at excess speeds. Regular maintenance is essential for safety and to maintain the level of performance.
- Allow the motor to cool down before putting the machine away.

## Danger ! Petrol is highly inflammable !

- Store fuel in containers specially designed for it. Always fill the tank outdoors and do not smoke while doing it.
- Do not unscrew the fuel cap or top up with petrol while the motor is running or still hot.
- If petrol is spilled on the ground, do not try to start the motor; Carry the machine elsewhere and avoid all naked flames until the petrol vapour has dispersed.
- Store the machine in a dry place. Never store the machine in a building where the petrol vapour can reach a flame, spark or source of intense heat.
- Replace the caps of the fuel tank and the petrol can correctly.
- Limit the amount of petrol in the tank to reduce spillage.
- Do not run the motor in a confined space where carbon monoxide vapour might accumulate.
- Carbon monoxide can be fatal. Ensure good ventilation.

## Moving, handling, transporting.

- Any action on the machine apart from ground digging must be performed with engine stopped and spark plug disconnected.
- Except when (ground digging) the machine must be moved by using the transport wheel as described in "Moving" chapter.
- Handling: do not try and lift the machine. The machine's weight is indicated on the manufacturer's plate, at the end of this manual. Use a method of handling adapted to the weight of the machine and to the situation to guarantee the safety
- When loading or unloading the machine to or from a trailer, use a suitable ramp. Lash the machine down correctly for safe transport.
- The machine should be transported in a trailer; do not use any other method of transport.

# DEFINITION OF THE PICTOGRAMS

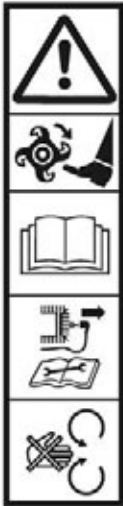

- WARNING**  
Danger
- WARNING**  
Rotating tools
- WARNING**  
Read the User's Manual
- WARNING**  
Consult the User's Manual and remove the sparkplug before performing any work.
- WARNING**  
Do not use without protection (rotating elements).

## Gas control

(depending on the engine)

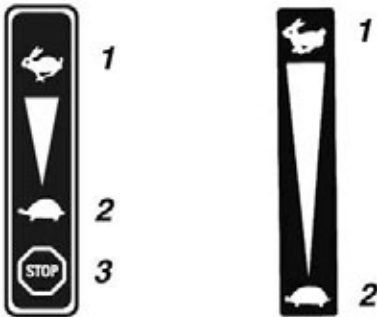

- 1 - Fast  
2 - Slow  
3 - Stop



Reverse Forward



Reverse

## Clutch lever



1 2

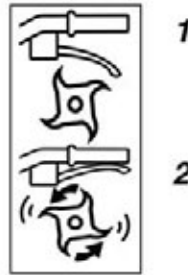

- 1 - Disengaged  
2 - Engaged

## Circuit cutout

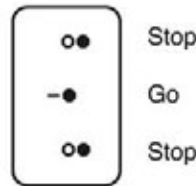

- Stop  
Go  
Stop



Do not touch any hot surfaces.



The exhaust gases are dangerous. Do not use in a poor ventilated area.



Switch off the engine before topping up the fuel.



Do not smoke, ignite a flame or approach with a naked flame.

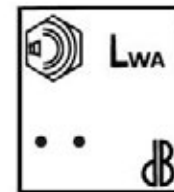

Guaranteed sound power level



Wear a helmet with ear defenders.



Pictograms present or not depending on the model of the machine.

EN

DE

FR

ES

IT

NL

# TECHNICAL INFORMATION

Machine model	MFT85 160R	Acoustic pressure level at driver's seat ( EN709 : 1997 / A4 : 2009 )	dB(A)	85
Weight	kg 52	Measurement uncertainty	dB(A)	1
Engine model	GX160	Measured acoustic pressure level ( EN709 : 1997 / A4 : 2009 )	dB(A)	98
Net output (*)	KW 3.6	Measurement uncertainty	dB(A)	1
For engine revolutions	rpm 3600	Vibration level transmitted to operator's hands ( EN709 : 1997 / A4 : 2009 )	m/s <sup>2</sup>	7
Nominal power	KW 3.6	Measurement uncertainty	%	2
Nominal engine revolutions	rpm 3600			
Guaranteed acoustic pressure level	dB(A) 100			

\* The engine power indicated in this document is the net output obtained by testing an engine from a production run according to Standard SAE J 1349 at a given speed of rotation. The power of another production run engine may differ from this indicated value. The actual power of an engine installed in a machine depends on various factors such as the speed of rotation, the temperature, humidity, atmospheric pressure and maintenance conditions and other factors.

# UNPACKING / ASSEMBLY

EN

DE

FR

ES

IT

NL

NB: In his constant desire to improve his products, the manufacturer states that the whole of this manual is not contractual and reserves the right to modify the specifications of his machines without notice.



## Unpacking

1.1



**WARNING:**  
Take care not to cut the cables or scratch the machine's paintwork when cutting the edges of the case.

Ref.	Contents of the case
A	Engine block
B	Exhaust grill *
C	Instructions & parts pouch
D	Depth control spur
E	Right handlebar
F	Left handlebar
G	Handlebar brace
H	Transport wheel
I	Protective wings
J	Cutters
K	Optional additional cutters
L	Optional plant protection discs
M	Optional bracket cover

*\*(depending on the engine)*



## Assembling the machine

1.2



**WARNING:**  
Inappropriate assembly of this rotary tiller could cause severe injuries. Ensure that you follow all the instructions carefully.

1

2 Fitting the depth control spur

3

Fitting the handlebar support

4

5

6 Fitting the handlebars

7

8

9

10

Tightening the depth control spur

11

12 Fitting the transport wheel

13

14 Fitting the gas control

15

16 Fitting the clutch lever

17

18 Fitting the reversing lever  
*(depending on the version)*

19

Fitting the circuit cut-off  
*(depending on the engine)*

20

Fitting the cable clamp

21

Fitting the protective wings

22

23 Fitting the tools



**WARNING**  
After assembling the machine completely, tighten all the bolts and screws with moderation: do not overtighten

**NB:** Any dismantling operation must only be performed by an approved workshop.



## Description of the elements

1.7

- 1 - Gas control\*
- 2 - Engine
- 3 - Transport wheel
- 4 - Rotating tools
- 5 - ON / OFF switch \*
- 6 - Protective plate
- 7 - Earthing spur
- 8 - Belt cover
- 9 - Handlebar adjustment handle
- 10 - Clutch lever
- 11 - Reversing lever \*\*

*\*(depending on the engine)*

*\*\* (depending on the version)*



## Machine identification plate

1.4

- A - Nominal power
- B - Weight in kilograms
- C - Serial number
- D - Year of manufacture
- E - Type of machine
- F - Manufacturer's name and address
- G - CE identification
- H - XX = Rotary tiller with IC engine



## Transport wheel

1.5

A = Working position.  
B = Transport position.

# STARTING THE MACHINE



## Filling with oil and checking the level

2.1

- Top up the oil level in the engine casing.
- Top up the air filter box with identical oil up to the OIL LEVEL mark.



## Topping up the petrol

2.2

Super or lead-free or SP95 E10.



## Open the fuel valve and set the starter to position A

2.3



## Accelerator

2.4

Put the lever to:



## Circuit cutout

2.5

Set the circuit cutout to ON



## Pull the handle on the ignition cord

2.6



When the machine starts, remain within the safety zone.



## Starter

2.7

Set the starter to position B.

## USE

### Forward

3.1



It is essential to let out the clutch before using reverse.



Maintain a safety zone of 20 m in radius around the machine.

### Reverse

3.2



It is essential to let out the clutch before using reverse.



Maintain a safety zone of 20 m in radius around the machine.



The use of reverse is dangerous. Ensure that there are no obstacles behind you and reduce the engine revs before engaging the clutch.

EN

DE

FR

ES

IT

NL

## STOPPING

### Stopping the cutting tools

4.1

Release the clutch lever.

### Reduce the gas

4.2

Set the accelerator control to: 

### Stopping the engine

4.3

Set the circuit cutout to OFF

### Close the fuel tap

4.4

## MAINTENANCE TABLE

### Daily checks

Before starting the engine, check the following points.

- There must be no loosened or broken nuts or bolts.



4.5

- Cleanliness of the air filter element and the oil level.



Do not use inflammable solvent to clean the foam air filter element.



2.1

- Engine oil level.

- No leaks of petrol or engine oil.



2.2

- Sufficient petrol.

- Environment protection.

- No vibrations or excessive noise.

### First month or after 20 hours

- Renew the engine oil

### Every 3 months or 50 hours

- Clean the air filter (1)

### Every 6 months or 100 hours

- Renew the engine oil
- Clean decantation cup
- Clean the spark shields
- Clean fuel tank and fuel filter

### Every year or 300 hours

- Replace the ignition spark plug
- Check – Adjust the tickover speed (2)
- Check – Adjust the play in the valves (2)

### After every 500 hours

- Clean the combustion chamber (2)

### Every 2 years (Replace if necessary)

- Check the fuel pipe (2)

#### NOTE

(1) Service the air filter more often when it is used in dusty environments.

(2) These operations must be entrusted to an approved Honda dealer, if the user does not have the necessary tools and is not mechanically qualified. Please refer to the Honda workshop manual.

## MOVING AND HANDLING

EN



← Moving

DE



Stop the engine.

FR



Set the wheel in movement position.

ES

IT

## ADJUSTING THE CLUTCH CABLE

NL



When advancing jerkily or when the blades are not turning in the "Clutch engaged" position, adjust the clutch cable.



Stop the machine and disconnect the spark plug.



Release the cable tensioning nut on the clutch cable.



Set the tensioning nut to provide 20mm play at the end of the lever.



Relock the nut.

Reconnect the sparkplug.

Start the machine and try again.

If the problem persists, contact your retailer.

## ADJUSTING THE REVERSING CABLE



In the "clutch engaged" position, in the event of an abnormal noise or when the blades do not turn, adjust the reversing cable.



Stop the machine and disconnect the spark plug.



Release the cable tensioning nut on the reversing lever.



Set the tensioning nut to provide 5mm play at the end of the lever.



Relock the nut.

Reconnect the sparkplug.

Start the machine and try again.

If the problem persists, contact your retailer.