

Petrol Tiller (THTIL3.5)

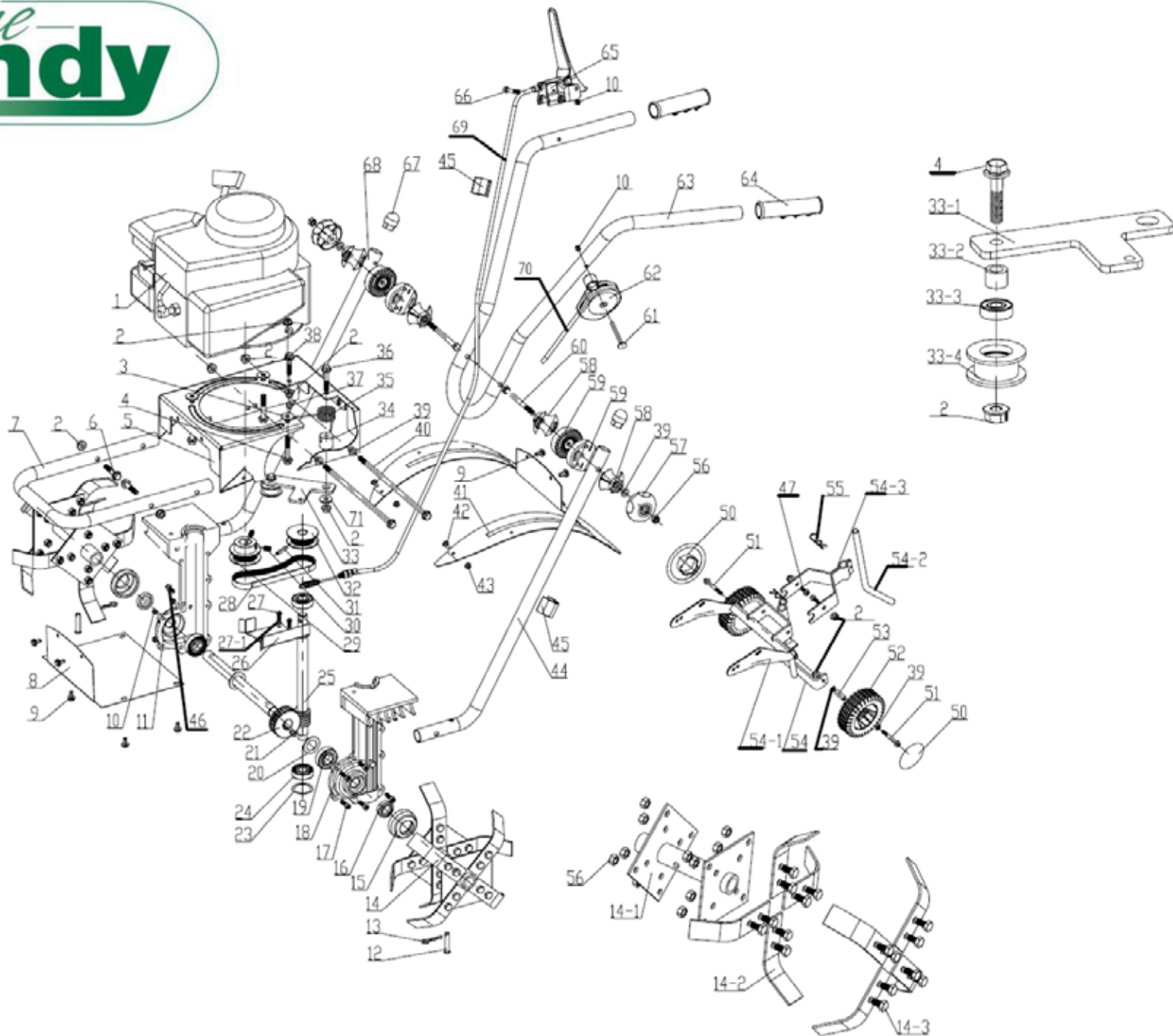



Petrol Tiller (THTILL3.5)

No	Part No	Description	QTY	No	Part No	Description	Qty
1	TH112-1	Gasoline Engine	1	33-4	TH112-33-4	Pulley Tightener	1
2	TH112-2	Lock Nut M8	14	34	TH112-34	Spring Axis	1
3	TH112-3	Washer 8	3	35	TH112-35	Pulley Tightener Spring	1
4	TH112-4	Hexangular Bolt M8X35	4	36	TH112-36	Hexangular Bolt M8X45	1
5	TH112-5	Basis	1	37	TH112-37	Bolt Cap	1
6	TH112-6	Hexangular Bolt M8X40	2	38	TH112-38	Hexangular Bolt M8X40	1
7	TH112-7	U Shape Syphone	1	39	TH112-39	Washer 8	9
8	TH112-8	Front Plant	1	40	TH112-40	Hexangular Bolt M8X250	2
9	TH112-9	Screw M6X12	10	41	TH112-41	Guard Plate	1
10	TH112-10	Locknut M6	11	42	TH112-42	Inner Hexangular Screw M5x12	8
11	TH112-11	Transmission Case L	1	43	TH112-43	Locknut M5	2
12	TH112-12	Shaft	2	44	TH112-44	L Shape Left Syphon	1
13	TH112-13	Fork2.5	2	45	TH112-45	Line Clip	3
14	TH112-14	Blade assembly	2	46	TH112-46	Bolt M8X10	1
14-1	TH112-14-1	Blade Jointing Set	2	47	TH112-47	Hexangular Bolt M8X20	2
14-2	TH112-14-2	Blade	16	50	TH112-48	Wheel Cover	2
14-3	TH112-14-3	Bolt M8X16	32	51	TH112-49	Hexangular Bolt M8X60	2
15	TH112-15	Bearing	2	52	TH112-50	Wheel	2
16	TH112-16	Close Oil FA20x32x7	2	53	TH112-51	Wheel Bush	2
17	TH112-17	Inner Hexangular Screw M6x25	9	54	TH112-52	Wheel Bracket Weldment	1
18	TH112-18	Transmission Case R	1	54-1	TH112-54-1	Fixing Bracket Weldment	1
19	TH112-19	Bearing	2	54-2	TH112-54-2	Stop-move staff	1
20	TH112-20	Washer	2	54-3	TH112-54-3	Stop-move Staff Bracket	1
21	TH112-21	Key	1	55	TH112-55	Fork3.0	2
22	TH112-22	Worm Wheel	1	56	TH112-56	Hexangular Nut M8	34
22-1	TH112-22-1	Output Axis	1	57	TH112-57	Revolving Handle	2
23	TH112-23	Washer	1	58	TH112-58	Clip Cover	4
24	TH112-24	Bearing	2	59	TH112-59	Clip Seat	4
25	TH112-25	Worm	1	60	TH112-60	Screw M8X100	2
26	TH112-26	Belt Groove	1	61	TH112-61	Square Neck Screw M6X60	1
27	TH112-27	Screw M5X8	2	62	TH112-62	Accelerograph Handle Assembly	1
27-1	TH112-27-1	Washer 5	2	63	TH112-63	Y Shape Syphon	1
28	TH112-28	Belt	1	64	TH112-64	Handle Cover	2
29	TH112-29	Engine Pulley	1	65	TH112-65	Brake Armguard Hold Assembly	1
30	TH112-30	Lock Screw M8X12	2	66	TH112-66	Inner Hexangular Screw M6x40	1
31	TH112-31	Lock Pin 5X40	1	67	TH112-67	Round Plug	2
32	TH112-32	Transmission Case Pulley	1	68	TH112-68	L Shape Right Syphon	1
33	TH112-33	Pulley Tightener Assy.	1	69	TH112-69	Clutch String	1
33-1	TH112-33-1	T Plate	1	70	TH112-70	Accelerograph String	1
33-2	TH112-33-2	Pulley Tightener Sleeve	1	71	TH112-71	Big Washer	1
33-3	TH112-33-3	Bearing608	1				