

INSTRUCTIONS

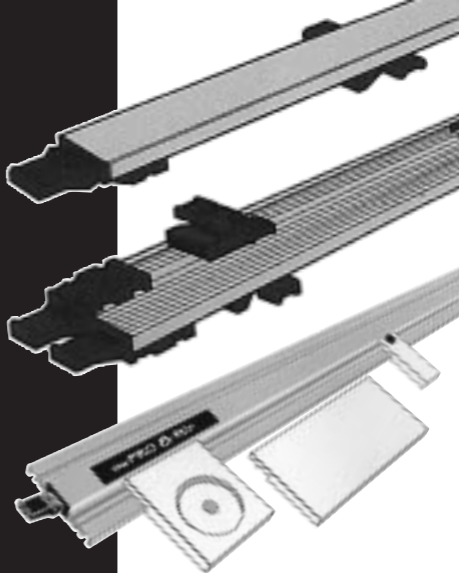

CLAMP GUIDE BENCH CLAMP PRO TRACK

trend[®]
routing technology

INST/CG V2.0

CLAMP GUIDE APPLICATIONS

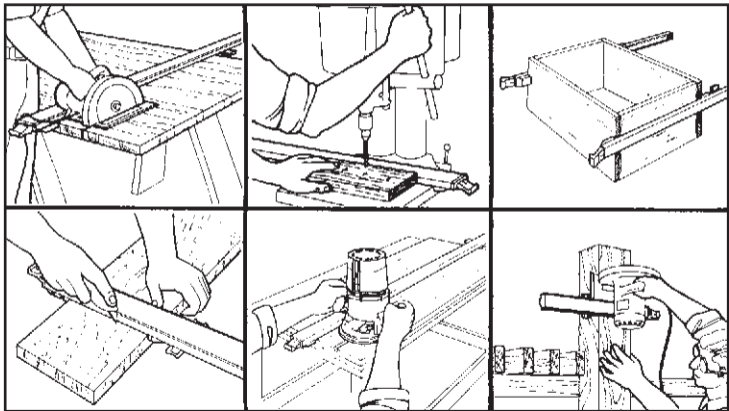

CLAMP GUIDE

The Clamp Guide is an obstruction free straight edge guide batten. It has instant adjustable edge to edge clamping facility with short powerful jaws that do not obstruct the operation. The clamps have a low profile to ensure obstruction free routing, sawing

and marking out. It can also be used as a back fence for drilling on a pillar drill.

To cut across the component a tri-square is used to set the clamp square and it then simply locks in position.

The Clamp Guides are supplied with soft jaw pads as standard.

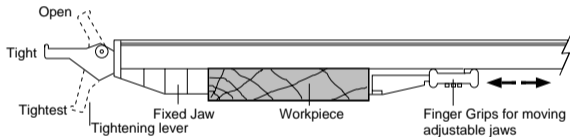

Offset distance

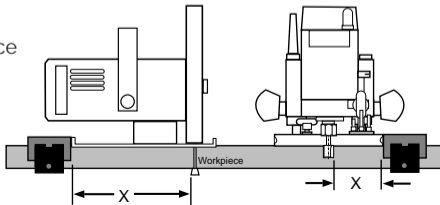

X= offset distance required from edge of clamp to edge of cutter or blade

BENCH CLAMP APPLICATIONS

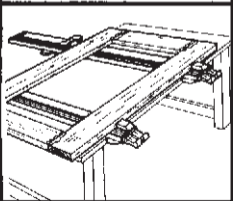
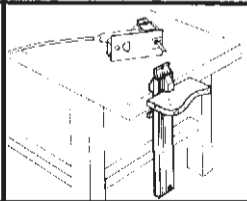
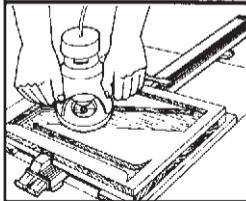
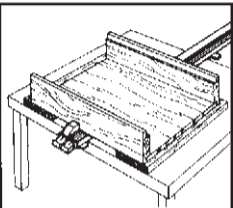
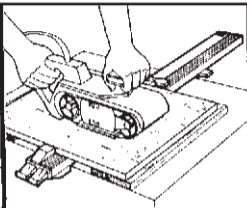
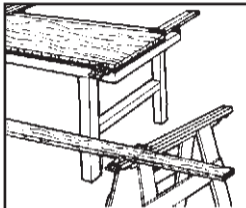

BENCH CLAMP

The Bench Clamps are equivalent to two clamps joined back to back, the top clamp holds your work securely while the bottom clamp grips your bench. They are supplied with soft jaw pads as standard.

Ideally two Bench Clamps ensure the material is held securely, however one clamp can be used if packing pieces are placed either side of the clamp. The clamp then holds the centre of the component.

ADJUSTABLE SLIDING JAW

For Clamp Guide refs. CG/24 to 50 and Clamp Guide Pro Track CG/PRO2 to 8 the adjustable sliding jaw has a grub screw adjustment facility which allows the slack to be taken up. Using the $3/32''$ A/F Allen key for this operation, tighten the grub screw clockwise until the sliding jaw will not move. Then back off the grub screw just enough to let the adjustable sliding jaw slide smoothly.

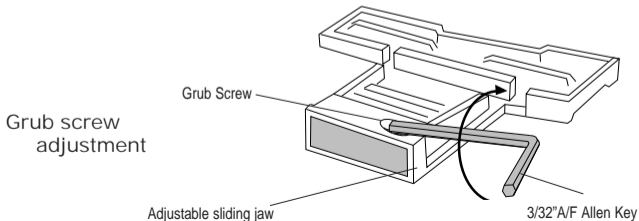

OPERATING INSTRUCTIONS

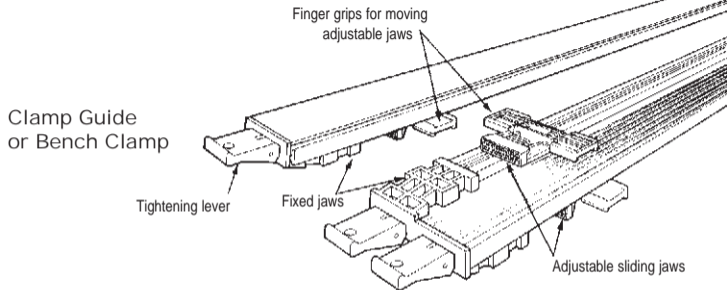

- Position the clamp with the tightening lever facing you.
- Push the finger grips away from you and place the workpiece between the jaws.
- Keep one edge of the workpiece pressed against the fixed jaw.
- Slide the adjustable jaw until it firmly presses against the opposite edge.
- Push the tightening lever down to grip the workpiece.
- To release, pull up the lever.
- A second stage of tightness can be achieved by pushing the lever down one, more position.

PRO TRACK

The Pro Track allows routers and circular saws to be guided in a straight line. It is secured to the material in the same way as the Clamp Guides.

The Pro Track has an extrusion that allows a router base or saw base to be fitted to the track. The polypropylene base ensures that a straight cut is achieved in either direction. The base plates can be secured to the track by sliding the T-nut along the extrusion and then fitting a washer and fixing knob to secure the plate to the T-nut. An End Stop Block is also offered for the Pro Tracks which can be locked in position to allow uniform stopped grooves to be machined.

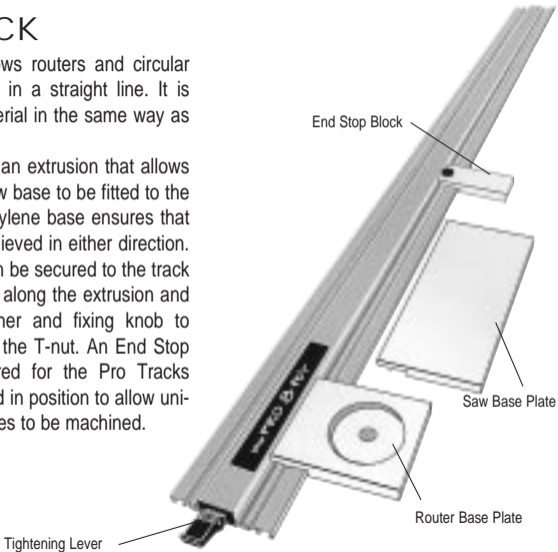

ROUTER BASE PLATE

The router base is supplied with a fixing kit that secures the router to the base plate. If the existing fixing holes in the base plate do not line up with the router, new holes can be drilled and countersunk.

The base plate is also designed to allow a 30mm OD template guide bush to be used to fit the router to the base plate. The guide bush locates in the central hole of the plate.

END STOP BLOCK

The end stop block has a locking device to secure its position on the track. The end stop can be secured to the track by sliding the T-nut along the extrusion and then fitting a washer and locking knob to secure the end stop block to the T-nut. By tightening the knob the end stop block can be set at the required position. It has a rebate on the underside edge so as to ensure that wood chips do not effect the length of cut

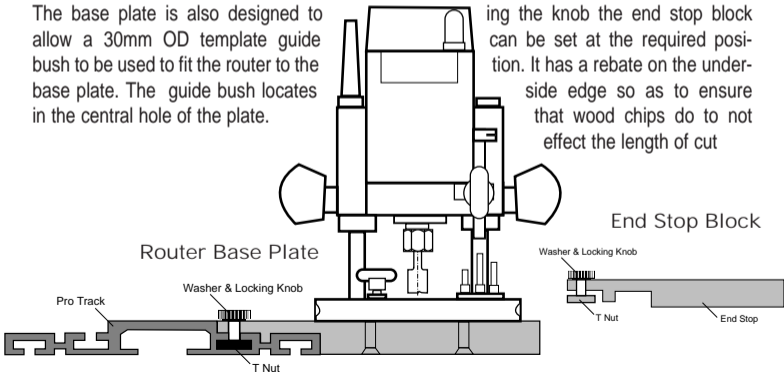

SAW BASE PLATE

The saw base is supplied with a fixing kit for the user to drill their own holes. The circular saw should be positioned on the plate with the blade and guard overhanging the edge which is opposite the track. This is to allow the guard to function properly. Ensure that the base of the saw is parallel to the saw base and Pro Track.

Once positioned correctly, clamp the circular saw to the plate and either use existing holes in the circular saw shoe or drill new holes, (4 holes suggested) through the base plate, and countersink from the underside. Using the fixing kit supplied secure the saw to the plate.

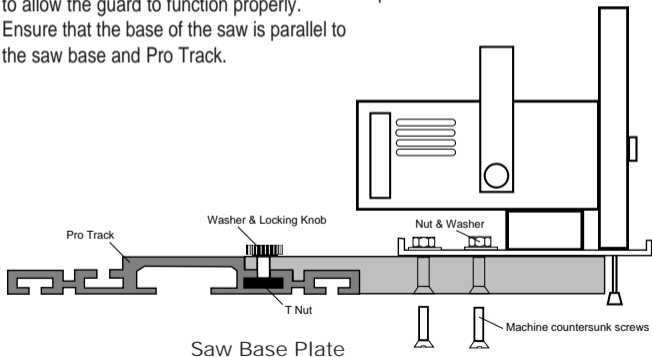

SOFT JAW PADS

These soft jaw pads will give added grip on harder and smoother surfaces than the normal jaws. They will also protect softer materials from being marked. The soft jaws simply clip onto the bar.

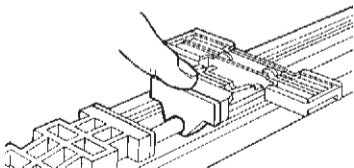

Trend Machinery & Cutting Tools Ltd.
Watford England
Manufactured by Grisit Industries Inc.
Santa Ana CA92705 USA

CLAMP GUIDE RANGE:

CLAMP GUIDE	24"	610mm	CG/24
CLAMP GUIDE	36"	915mm	CG/36
CLAMP GUIDE	50"	1270mm	CG/50

BENCH CLAMP	18"	460mm	CG/BB18
BENCH CLAMP	36"	915mm	CG/BB36
BENCH CLAMP	50"	1270mm	CG/BB50

PRO TRACK	2'	610mm	CG/PRO2
PRO TRACK	4'	1220mm	CG/PRO4
PRO TRACK	8'	2440mm	CG/PRO8

ACCESSORIES for PRO-TRACK:

ROUTER BASE PLATE	CG/PRO/RBP
SAW BASE PLATE	CG/PRO/SBP
END STOP BLOCK	CG/PRO/ESB
TEE NUT KIT	CG/PRO/TNK
PRO KIT	CG/PRO/KIT

SPARES:

SOFT JAWS	4 off	CG/01
NYLON JAW KIT	1 off	CG/02