



EXTRACTION

Product range

FESTOOL
Tools for the toughest demands

Mobile dust extractors from Festool.

Progress at its best.

Clean work is important: for protecting health, creating a good impression with customers and smooth work processes with precise results. Not only the final cleaning must be thorough, but also the extraction directly at the power tool or compressed air tool. That's why we have already been including the mobile dust extractors as a fixed component in the Festool system for many years and are consistently extending our offering, for example with our new special application extractors.

The special benefits are often in the detail. For example with the typical Festool innovations such as the hose garage, which makes the outer hook on the container redundant. The SYS-Dock for connecting to the SYSTAINER for more space and order. A suction hose optimised to a 27 mm diameter, which extracts even cumbersome materials and is clearly more flexible. Or the variable suction power adjustment and standard automatic electronic switch-on/shut-off for quick, clean work.

Our aim: to construct mobile dust extractors which accelerate the work processes. That are lightweight and robust, with lots of space for compact dimensions. Which guarantee cleanliness – during and after work. And, of course, which become even that little bit better in the future.

Contents

| | |
|---|----|
| ▶ Systems get it done | 04 |
| ▶ Mobile dust extractors CT MINI/CT MIDI | 06 |
| ▶ Mobile dust extractors CLEANTEX CT 26 CT 36 CT 48 | 08 |
| ▶ Special extractors CLEANTEX AUTOCLEAN CT AC PLANEX | 10 |
| ▶ Special extractors CLEANTEX CTH 26 CTH 48 | 12 |
| ▶ Special extractors CLEANTEX CT 48 LE EC | 14 |
| ▶ Special extractors CLEANTEX CT 48 LE EC/B22 | 16 |
| ▶ Overview of mobile dust extractors and special extractors | 18 |
| ▶ Festool filter bags | 19 |
| ▶ Accessories and consumable materials | 20 |
| ▶ Scope of delivery and order numbers | 22 |





AUTOCLEAN technology
Less work at constant suction power: Manual cleaning of the main filter is now a thing of the past thanks to the automatic AUTOCLEAN function. Cleaner results are guaranteed for the most diverse demands with the variable cleaning interval setting and suction power.



Full usage of space
Perfectly coordinated components create the optimum space for all quantities of dust. A sophisticated container geometry with a precisely defined SELFCLEAN filter bag and minimal flat filter together result in a net volume that matches the gross volume.



SYS-Dock and hose garage
Festool innovations: the SYS-Dock for connecting to the Systainer for simple transportation of the tool and accessories. Or the unique integrated hose garage with cord holder, which can also be used as a storage station.



Quality tools "Made in Germany"
Many of our tools have already been in use for over 30 years. This is no coincidence but a logical consequence of the careful development and production "Made in Germany". Our products live up to the promise: tools for the toughest demands.



Because things **work better** when everything fits together.



Systems get it done.

Whoever wants to be good needs the perfect tool. Whoever wants to be better needs a system. A system in which accessories and consumables go hand-in-hand with the tools. A system that stands for more order and organisation. And a system that represents added value with each investment.

A system that only has one goal: to achieve more success even more quickly and easily.

System = added value

Many of the Festool mobile dust extractors are equipped as standard with an integrated hose garage, SYS-Dock for holding the Systainer and power outlet modules. A handle or removable tool holder can be added as an option. Moreover, they are not only compatible with all Festool power and compressed air tools, but also the various accessories are interchangeable.



System = continuous work process

For problem-free work processes every detail counts: Festool mobile dust extractors guarantee a clear view of the work area. To accelerate processes the plug-it hose guarantees the change of machines at lightning speed. Improved handling with the plug-it hose and integrated network cable. And for work with the guide rail a deflector ensures that the suction hose does not become tangled.

System = better organised

The mobile dust extractors from Festool not only provide assistance in matters of cleanliness but they also make it easier to keep things in order. The SORTAINER and Systainer can be connected securely to the extractors using the SYS-Dock. Used with a workcenter* or toolcenter* they become a mobile work station. And the action radius in the workshop can be enlarged considerably when the energy box or the boom arm are used.

* not compatible with CT MINI/MIDI

Mobile dust extractors CT MINI | CT MIDI

Ideal for **carrying en route.**

Dust class

L

Tools

Electric

Compact and lightweight: These features make the CT MINI and CT MIDI mobile dust extractors the ideal companion for assembly, installation and renovation work. For work with power tools or for final cleaning when extracting dust or water.

- ▶ Always on hand – the CT MINI and CT MIDI are easy to transport thanks to their minimum weight and compact dimensions
- ▶ Powerful system – the CT MINI and CT MIDI are equipped with the same high-performance turbine as the large CLEANTEX models
- ▶ Even more capacity – the SELFCLEAN non-woven filter bags can hold up to 4 times more fine dust than conventional filter bags
- ▶ Systematic extension – machines and accessories in the Systainer are secured to the SYS-Dock at cyberspeed
- ▶ Secure position – the locking brake holds the mobile dust extractor firmly in place
- ▶ Optimal usage of the container volume – thanks to the flat filter and smooth inner contour



CT MINI | CT MIDI

| Technical data | CT MINI | CT MIDI |
|--------------------------------------|----------------------|--------------------|
| Power consumption | 400-1200 W | |
| Airflow max. | 3700 l/min | |
| Max. vacuum | 24000 Pa | |
| Filter surface area | 5000 cm ² | |
| Rubber-insulated mains cable | 7.5 m | |
| Container/Filter bag capacity | 10/7.5 l | 15/12.5 l |
| Dimensions (L x W x H) | 440 x 340 x 420 mm | 440 x 340 x 470 mm |
| Max. appliance socket connected load | 2400 W | |
| Weight | 8.7 kg | 9.0 kg |

Scope of delivery | Order numbers from page 22



For system accessories and consumables
see from page 22



The hose and network cable are protected in the integrated hose garage.



Quick and simple replacement of the main filter and filter bag without using any tools.



Sophisticated detail too – the separate storage compartment for replacement filter bags.

All-rounder in the perfect size.

Dust class

L, M

Tools

Electric
Compressed air module

Compact but still big. Lightweight but still powerful. Whether it's for the construction site or the workshop – thanks to its sophisticated container geometry the CLEANTEX offers lots of space with small outer dimensions. With three different sizes the right model is available for every demand.

- ▶ Minimal flat filter – the net volume matches the gross volume
- ▶ Suitable for every demand – the CT series is available for dust classes M and L and can be individually equipped with an additional power outlet (for continuous current or with automatic electronic switch-on/shut-off), a compressed air module or a module for connecting to the energy box (EAA)
- ▶ Extremely small, extremely powerful – compact high-performance turbine with high suction power
- ▶ Order and protection – with cord holder, SYS-Dock for Systainer of sizes 1-5 and hose garage, which also serves as a storage station
- ▶ Self-cleaning and tear-proof – the robust non-woven filter bags collapse when the mobile dust extractor is switched off so that the dust is shaken off



CT 26 | CT 36 | CT 48



| Technical data | CT 26 | CT 36 | CT 48 |
|--------------------------------------|--------------------|----------------------|----------------------|
| Power consumption | | 350-1200 W | |
| Airflow max. | | 3900 l/min | |
| Max. vacuum | | 24000 Pa | |
| Filter surface area | | 6318 cm ² | |
| Rubber-insulated mains cable | | 7.5 m | |
| Container/Filter bag capacity | 26/24 l | 36/34 l | 48/46 l |
| Dimensions (L x W x H) | 630 x 365 x 540 mm | 630 x 365 x 596 mm | 740 x 406 x 1005 mm* |
| Max. appliance socket connected load | | 2400 W | |
| Weight | 13.9 kg | 14.4 kg | 18.8 kg |

* including handle | Scope of delivery | Order numbers from page 22



For system accessories and consumables
see from page 22



The Festool modular system.
Prepared for every task.



Because of the modular plug-in system, every CLEANTEX product can be ideally matched to meet your requirements.

1. Compressed air module
2. Energy box module
3. Second power outlet with continuous current or automatic electronic switch-on/shut-off

Safe and long-lasting – with locking brake, robust steel axis at the rear and large low-friction wheels, which move the CLEANTEX without tilting, even over steps.



Suction power [%]

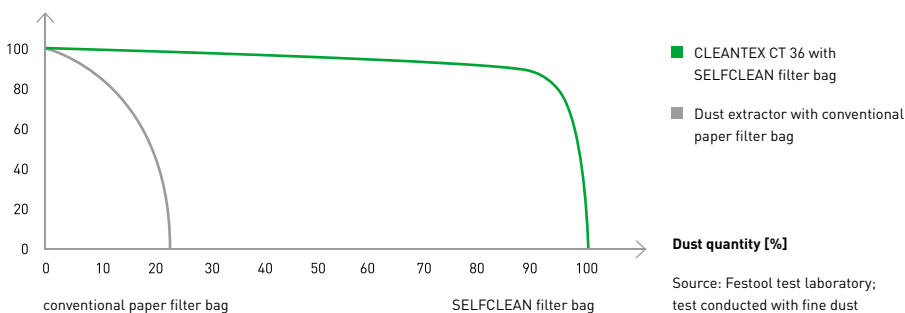

Hard to beat – constant high suction power and up to four times more fine dust extracted with the SELFCLEAN filter bag.



SELFCLEAN filter bag – no filter cakes build up here, the suction power remains constant until the bag is completely full.

Mobile dust extractors CLEANTEX CT 26 AC | CT 36 AC |
CT 36 AC PLANEX | CT 48 AC

Fully automatic filter cleaning system.

| Dust class |
|-----------------------------------|
| L, M |
| Tools |
| Electric Compressed air module |

Defence against clogged filters: the new CLEANTEX AUTOCLEAN. With automatic filter cleaning and constant, powerful suction power already in the basic models.

In addition, the CT 36 AC PLANEX special application extractor was developed for extreme suction power of the PLANEX long-reach sander – with tool holder, robust, bend-resistant hose and standard ComfortClean locking slide.

- ▶ Minimal high-performance turbine, high-performance flat filter and complete usage of the container
- ▶ Variable cleaning interval setting – from 15 seconds to 2 minutes
- ▶ Completely clean – with the disposal bag, which is available as an accessory, you practically come into no contact with dust
- ▶ Meets the requirements for an M model, which are prescribed for the extraction of mineral fillers and filling materials



CT AC | CT AC-PLANEX



product
design
award
2009

| Technical data | CT 26 AC | CT 36 AC CT 36 AC PLANEX | CT 48 AC |
|--------------------------------------|--------------------|----------------------------|----------------------|
| Power consumption | | 350-1200 W | |
| Airflow max. | | 3900 l/min | |
| Max. vacuum | | 24000 Pa | |
| Filter surface area | | 6318 cm ² | |
| Rubber-insulated mains cable | | 7.5 m | |
| Container/Filter bag capacity | 26/24 l | 36/34 l | 48/46 l |
| Dimensions (L x W x H) | 630 x 365 x 540 mm | 630 x 365 x 596 mm | 740 x 406 x 1005 mm* |
| Max. appliance socket connected load | | 2400 W | |
| Weight | 14.7 kg | 15.2 kg | 19.6 kg |

* including handle Scope of delivery | Order numbers from page 22



For system accessories and consumables see from page 22

New technology: CLEANTEX AUTOCLEAN

The automatic filter cleaning system keeps the filter clean and maintains a constant high suction power.

The cleaning intervals are variable and can be set from 15 seconds to 2 minutes: short for large dust quantities, long for minimum dust quantities.

One-touch cleaning can be initiated at any time between the set intervals.

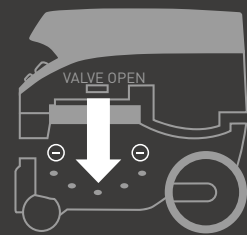

The valve is opened magnetically during the cleaning interval. The vacuum in the container draws air through the filter, accumulated dust comes loose and falls into the container.



Extreme vacuum for extreme cleaning – the filter is cleaned even more intensely through the ComfortClean locking slide.

When the spontaneous AC cleaning function is turned on the filter is cleaned several times. The cleaning can be switched off completely for liquids.

Special application extractors CLEANTEX CTH 26 | CTH 48

No chance for **hazardous dust.**

Dust class

H

Tools

Electric

Compressed air module

Asbestos, mould, mineral fibre dust, cadmium, lead, nickel, zinc chromate. Many dangers – one defence: carcinogenic and pathogenic dust have no chance with the CTH special application extractors from Festool. With a 99.995%* degree of filtration even mould removal and asbestos abatement or wood-working with dangerous impregnating compounds pose no health problems.

- ▶ Protects health – approval for dust classes M and category H, suitable for carcinogenic and pathogenic dust
- ▶ Secure seal – with the double-layered safety filter bag
- ▶ Lots of space, lots of power – thanks to the flat filter and high-performance turbine
- ▶ Automatic power delivery – with variable suction power control and also antistatic function
- ▶ Stationary or mobile – available in sizes 26 or 48

NEW



CTH 26 | CTH 48

| Technical data | CTH 26 | CTH 48 |
|------------------------------------|--------------------|-----------------------|
| Power consumption | | 350-1000 W |
| Airflow max. | | 3900 l/min |
| Max. vacuum | | 24000 Pa |
| Filter surface area | | 6318 cm ² |
| Rubber-insulated mains cable | | 7.5 m |
| Container/Filter bag capacity | 26/24 l | 48/46 l |
| Dimensions (L x W x H) | 630 x 365 x 540 mm | 740 x 406 x 1005 mm** |
| Load connected to appliance socket | | max. 2400 Watt |
| Weight | 13.9 kg | 18.8 kg |

* Product satisfies design approval for dust class H, see page 23 ** with handle Scope of delivery | Order numbers from page 22



For system accessories and consumables
see from page 22



Comfortable grip – using the handle the CTH 48 is easy to move to the place of use.



The double-layered safety filter bag ensures dust-free disposal.



Special application extractor with system connection – Systainers can be connected simply to the CTH.

Special application extractors CLEANTEX CT 48 LE EC

Created for continuous operation in industry.

Dust class

L, M

Tools

Electric
Compressed air

Tough continuous operation is its speciality – and its EC-TEC drive concept which guarantees more reliability, longer life and exceptional energy efficiency. For relentless suction power when processing plastics, ceramics, wooden or painted surfaces.

- ▶ Persistently strong – thanks to the innovative EC-TEC drive with up to ten times longer service life in comparison to conventional universal motors
- ▶ Variable for every demand – available for dust class L or M
- ▶ Solid base – equipped for connection to the energy box, as well as with a compressed air connection and SYS-Dock
- ▶ Flexible power – the suction power adjustment can be used to adjust the CT 48 LE EC to the respective work situation
- ▶ No chance for electrostatic charge – thanks to antistatic function



NEW

CT 48 LE EC

| Technical data | CT 48 LE EC |
|------------------------------------|----------------------|
| Power consumption | 150-1100 W |
| Airflow max. | 3400 l/min |
| Max. vacuum | 23000 Pa |
| Filter surface area | 6318 cm ² |
| Rubber-insulated mains cable | 7.5 m |
| Container/Filter bag capacity | 48/46 l |
| Dimensions (L x W x H) | 630 x 406 x 640 mm |
| Load connected to appliance socket | max. 2400 Watt |
| Weight | 17.9 kg |

Scope of delivery | Order numbers from page 22



For system accessories and consumables
see from page 22



Enormous capacity – the net volume matches the gross volume due to the smooth, easy-to-clean inner contour of the container and the flat filter.



EC-TEC – at Festool this stands for a wear-free drive concept without carbon brushes and is thus maintenance-free and extremely robust.

Special application extractors CLEANTEX CT 48 LE EC/B22

For maximum safety.

Dust class

L, M

Tools

Electric
Compressed air

The special application extractor CT 48 LE EC/B22 specialises in the extraction of flammable and explosive dust. It is prepared for continuous work with the EC-TEC drive. The robust ABS plastic container has additional flame protection and is therefore suitable for the safe extraction of aluminium, paper, soot and powder coating material dust, as well as glass-reinforced and char-strengthened plastics.

- ▶ Complies with ATEX directive for zone 22 – dust of explosion classes ST1, ST2 and ST3 are safely removed
- ▶ Optimum usage of space – the compact, rectangular design ensures optimal filling of the filter bag
- ▶ Practical application – this special application extractor requires no separate carriage, its wheels are, like for all CLEANTEX models, robust, flexible and directly on the container
- ▶ Standard system – equipped for connection to the energy box, as well as with compressed air connection and SYS-Dock
- ▶ Antistatic function – to prevent electrostatic charge an antistatic hose, stainless steel tube and nozzles are available as accessories



NEW



CT 48 LE EC/B22

| Technical data | CT 48 LE EC/B22 |
|------------------------------------|----------------------|
| Power consumption | 150-1100 W |
| Airflow max. | 3400 l/min |
| Max. vacuum | 23000 Pa |
| Filter surface area | 6318 cm ² |
| Rubber-insulated mains cable | 7.5 m |
| Container/Filter bag capacity | 48/46 l |
| Dimensions (L x W x H) | 630 x 406 x 640 mm |
| Load connected to appliance socket | max. 2400 Watt |
| Weight | 18.6 kg |

Scope of delivery | Order numbers from page 22



For system accessories and consumables see from page 22



Increased safety – the countersunk power outlet and the design without hollows minimises the risk of the possible storage of explosive dust.

Festool mobile dust extractors and special application extractors

All tools at a glance.

Ideal for carrying en route.

CT MINI/MIDI

Compact and lightweight: ideal for assembly, installation and renovation work.



All-rounder in the perfect size.

CLEANTEK CT 26/36/48

Available in three sizes for every demand: the all-rounder for construction sites or workshops.



Fully automatic filter cleaning system.

CLEANTEK CT 26/36/48 AC | CT 36 AC PLANEX

Automatic, variable AUTOCLEAN filter cleaning function for constant suction power: perfect for large dust quantities.



No chance for hazardous dust.

CLEANTEK CTH 26/48

99.995% degree of filtration: especially suited to the extraction of carcinogenic and pathogenic dust.



Created for continuous operation in industry.

CLEANTEK CT 48 LE EC

With long-lasting EC-TEC drive concept: for tough continuous application and work in quasi-stationary operation of the energy box.



For maximum safety.

CLEANTEK CT 48 LE EC/B22

Safe and robust EC-TEC motor and container made from ABS plastic with flame protection: the specialist for work with flammable and explosive dust.





Festool filter bags

Pure quality every time.

A suitable filter bag designed for the dust class and material to be extracted is available for all mobile dust extractors from Festool:

- ▶ **SELCLEAN filter bag:** for unique use for all dust types. Prevents the build-up of filter cakes thanks to the self-cleaning function and is closed before disposal for maximum health protection.
- ▶ **Longlife filter bag:** suitable for multiple use thanks to high-tensile, triple-layered polyester non-woven material. Ideal for large dust quantities of class L. Simple emptying by opening the seal.
- ▶ **Disposal bag:** perfect for dust extractors with AUTOCLEAN, e.g. for use with the PLANEX long-reach sander or the extraction of coarse dirt and chips and swarf. Dust-free disposal through a seal on the disposal bag.
- ▶ **Double-layered safety filter bag:** required for class H dust. Particularly safe with additional disposal bag, which encases the non-woven filter bag.



| Mobile dust extractors/ Special extractors | Design approval | Filter bags | | | |
|---|-----------------|-------------|----------|----------|--------------|
| | | Dust class | SELCLEAN | Longlife | Disposal bag |
| CT MINI/CT MIDI | L | ● | | | |
| | M | ● | | | |
| CT 26 | L | ● | ● | | |
| | M | ● | ○ | | |
| CT 26 AC | L | ○ | ○ | ● | ● |
| | M | ○ | ○ | ● | |
| CT 36 | L | ● | ● | | |
| | M | ● | ○ | | |
| CT 36 AC | L | ○ | ○ | ● | |
| | M | ○ | ○ | ● | |
| CT 48 | L | ● | ● | | |
| | M | ● | ○ | | |
| | H | | | | ● |
| CT 48 AC | L | ○ | ○ | ● | |
| | M | ○ | ○ | ● | |
| CT 48 LE EC | L | ● | ● | | |
| | M | ● | ○ | | |
| CT 48 LE EC/B22 | L | ● | | | |
| | M | ● | | | |

● suitable and recommended

○ Possible, but with limitations

Scope of delivery | Order numbers from page 22

Mobile dust extractors and special application extractors

Accessories and consumable materials.

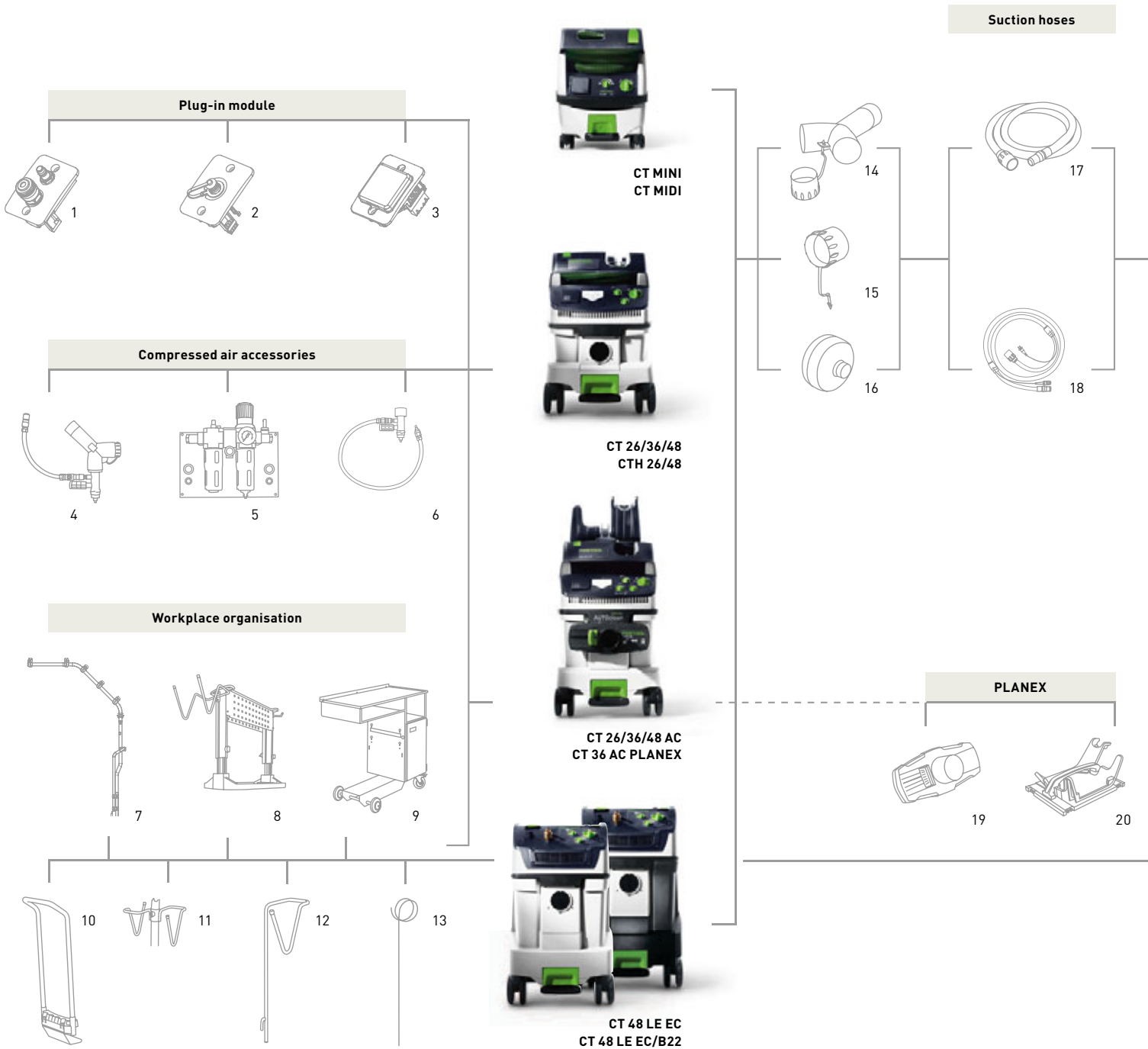



More system accessories and consumables are available at www.festool.co.uk or in the main catalogue.

Hose sleeves

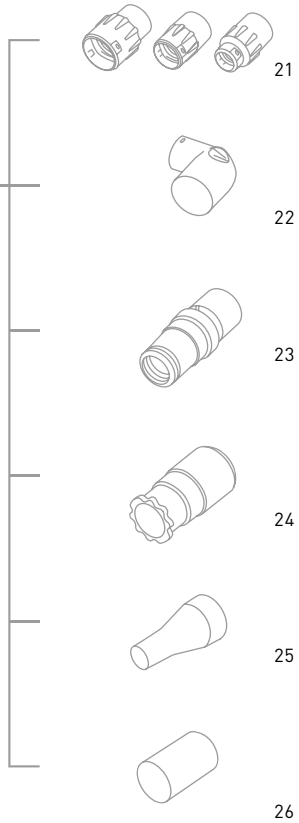

Tubes

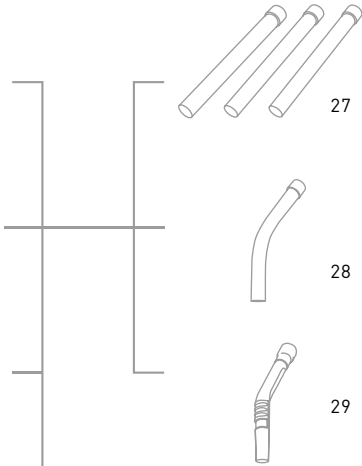

Nozzles and brushes

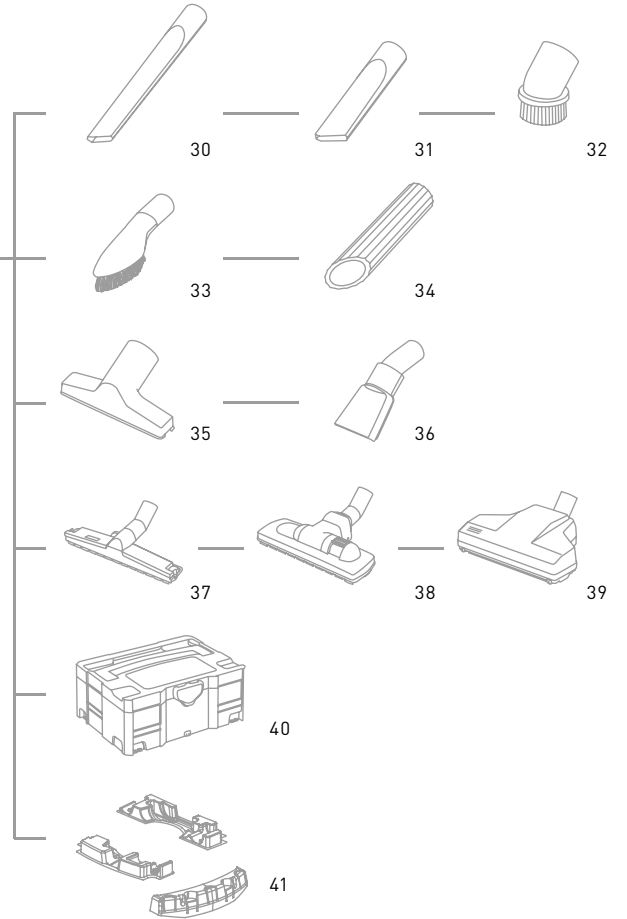

Filter

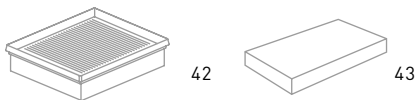

Filter bags

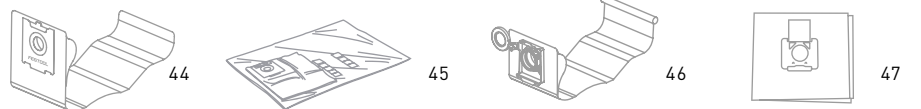

Scope of delivery and order numbers.

| CT | Container volume | Dust class | Electronics | Compressed air | AUTOCLEAN | EC-TEC motor |
|----------|------------------|--------------|-------------|----------------|-----------|--------------|
| CLEANTEK | 26, 36, 48 | L, M, H, B22 | E | LE | AC | EC |

| Mobile dust extractors CT MINI CT MIDI | Scope of delivery | Order no. | L | M | H | LE | AC | EC | B22 |
|---|---|---------------|---|---|---|----|----|----|-----|
| | SELF-CLEAN filter bag, replacement filter bag in the storage compartment, suction hose Ø 27 x 3.5 m AS with rotating angle adapter on suction side, in a box | | | | | | | | |
| CTL MINI 240V | | 583358 | ● | | | | | | |
| CTL MIDI 240V | | 583374 | ● | | | | | | |
| <hr/> | | | | | | | | | |
| Mobile dust extractors CT 26/36/48 CT 26/36/48 AC CT 36 AC PLANEX | Scope of delivery | Order no. | L | M | H | LE | AC | EC | B22 |
| | SELF-CLEAN filter bag, suction hose Ø 27 x 3.5 m AS, hose garage, cord holder, in a box | | | | | | | | |
| CTL 26 E 110V | | 583498 | ● | | | | | | |
| CTL 26 E 240V | | 583499 | ● | | | | | | |
| CTL 26 E AC GB 110V + disposal bag | | 584020 | ● | | | | ● | | |
| CTL 26 E AC GB 240V + disposal bag | | 584021 | ● | | | | ● | | |
| CTM 26 E GB 240V | | 584003 | ● | ● | | | | | |
| CTL 36 E GB 110V | | 583843 | ● | | | | | | |
| CTL 36 E GB 240V | | 583844 | ● | | | | | | |
| Mobile dust extractor, CTM 36 E AC-PLANEX GB 110V | Special extractor for the PLANEX long-reach sander LHS 225.; approved for dust class M; for mineral dust; container/filter bag capacity 36/34 0 l; PLANEX tool holder | 584061 | | ● | | | | ● | |
| Mobile dust extractor, CTM 36 E AC-PLANEX GB 110V | Special extractor for the PLANEX long-reach sander LHS 225.; approved for dust class M; for mineral dust; container/filter bag capacity 36/34 0 l | 584053 | | | | | | | |
| CTL 48 E AC GB 240V | | 584098 | ● | | | | | ● | |
| <hr/> | | | | | | | | | |
| Special application dust extractors | Scope of delivery | Order no. | L | M | H | LE | AC | EC | B22 |
| | CTH Double-layered safety filter bag, suction hose Ø 27 x 3.5 m AS, hose garage, cord holder, in a box | | | | | | | | |
| CTH 26 E GB 110V | | 584141 | | | | | | | ● |

| Design approval | Degree of filtration, filter system | Suitability |
|--|-------------------------------------|--|
| Dust class L ¹⁾ | > 99 % | Hazardous dust with limit values ³⁾ > 1 mg/m ³ |
| Dust class M ¹⁾ | > 99.9 % | Hazardous dust with limit values ³⁾ > 0.1 mg/m ³ |
| Dust class H ¹⁾ | > 99.995 % | Hazardous dust with limit values ³⁾ > 0.1 mg/m ³ |
| Mobile dust extractors, type 22 ²⁾ , dust class M | > 99.9 % | Flammable dust of explosion classes ST1, ST2 and ST3 in zone 22 |

¹⁾ Source: EN 60335-2-69 and IEC 60335-2-69 Annex AA ²⁾ Source: EN 60335-2-69 and IEC 60335-2-69 Annex CC

³⁾ Refer to the corresponding national regulations for limit values, e.g. TRGS 900 in Germany

| | Electrical outlet module* Scope of delivery | Order no. |
|---|---|--------------------------------|
| 1 | Compressed air module DL CT 26/36/48 for CT/CTL/CTM 26/36/48, for retrofitting mobile dust extractors in LE design, with additional compressed air automatic electronic switch-on/shut-off | 496141 |
| 2 | Energy box module EAA CT 26/36/48 for CT/CTL/CTM 26/36/48, for connecting a CT mobile dust extractor to the energy box or boom arm, mobile dust extractor not required in LE design, in a box | 496143 |
| 3 | Electrical outlet module for CT/CTL/CTM 26/36/48 SD module CT 26/36/48 Electrical outlet with continuous current SD module input/output CT 26/36/48 Electrical outlet with automatic On/Off switch | 496731 496405 |

* not for CT 48 LE EC or CT 48 LE EC/B22

| | Compressed air accessories Scope of delivery | Order no. |
|---|---|---------------|
| 4 | IAS 2 double adapter IAS 2-DA-CT for simultaneous connection of 2 IAS 2 compressed air tools in alternate operation (additional connection IAS 2-A-ASA/CT/SRM45/70 [454757] required), not for CT MINI/CT MIDI, external conus 58 mm, in a box | 496929 |
| 5 | Service unit VE-CT 26/36/48 for CT 26/36/48 in LE design, consisting of a quick drain outlet for the condensate, pressure regulator, oiler and oil-free compressed air outlet with quick-coupling, in a box | 495886 |
| 6 | IAS 2 connection IAS 2-A-ASA/CT/SRM45/70 for CT mobile dust extractors, for EAA in EW/DW design, for connecting to IAS 2 hoses, integrated connection for compressed air supply via compressed air connection hose, antistatic design, not for CT MINI/CT MIDI, external conus 58 mm, in a box | 454757 |

| | Workplace organisation Scope of delivery | Order no. |
|----|---|--------------------------------|
| 7 | CT boom arm tube set with connections, length 2119 mm, width: 1136 mm, in a box CT-ASA CT 26/36 SB for CT/CTL/CTM 26/36, with handle SB-CT 26/36 CT-ASA CT 44/48/55 for CT/CTL/CTM 48 | 496468 492452 |
| 8 | Work centre WCR 1000 compact mobile workplace with shelf, storage tray, shelf for pegboard, double tool hooks, universal hook, 6 standard hooks, (125 mm long), 2 pegboards with square boring, Systainer holder, in a box | 497471 |
| 9 | Toolcenter TC 3000/2 mobile workplace with large work and storage area, lockable tool cabinet with intermediate shelf for storing Systainers and Sortainers, extractor dock with fixing bow for CT/CTL/CTM 26/36/48 with strap [accessories] | 583881 |
| 10 | Handle with nozzle holder ZBA-D SB-CT 26/36 for CT/CTL/CTM 26/36 SB-CT 48 for CT/CTL/CTM 48 | 495802 497295 |
| 11 | Tool holder WHR/CT-ASA for CT-ASA, CT-ASA/SB for safe and ergonomic storage of two power/compressed air tools made from high-quality stainless steel | 493558 |
| 12 | Tool holder WHR-CT for CT/CTL/CTM 26/36/48 for the safe and ergonomic storage of power/compressed air tools made from high-quality stainless steel | 496122 |
| 13 | Hose holder SHR-CT/SR for CT/CTL/CTM 26, 36, 48 prevents stumbling over hoses on the ground, in a box | 487072 |

| | Accessories Scope of delivery | Order no. |
|----|--|---------------|
| 14 | Y-piece, antistatic D 50 SV-AS/D 50 V for D 50/D 36/D 27, with blanking plug, for connecting two suction hoses, simultaneous operation is not permitted for extractors with approval for hazardous dust | 452898 |
| 15 | Blanking plug D 50/V for closing the inlet nozzle, for retrofitting CT/CTL 26, CT/CTL 36, CT/CTL 48 | 452899 |
| 16 | Spark trap D 50 FL for CT/CTL/CTM, in a box | 484733 |

| | Suction hoses Scope of delivery | Order no. |
|----|---|---------------|
| 17 | Antistatic suction hoses temperature-resistant up to + 70°C, bleeder resistor (DIN IEC 312) < 10 MΩ, in a box | |
| | D 22x3.5 m AS Ø 22 mm, with rotating angle adapter and reducing sleeve, high flexibility: optimal for PS/LS/ETS/RTS/DTS/RS300/DX, length 3.5 m | 456745 |
| | D 27x3.5 m AS Ø 27 mm, with rotating adapter and reducing sleeve, length 3.5 m | 452878 |
| | D 27x5 m AS Ø 27 mm, with rotating adapter and reducing sleeve, length 5 m | 452880 |
| | D 36x3.5 m AS Ø 36 mm, with rotating adapter and reducing sleeve, length 3.5 m | 452882 |
| | D 36x5 m AS Ø 36 mm, with rotating adapter and reducing sleeve, length 5 m | 452884 |
| | D 36x7 m AS Ø 36 mm, with rotating adapter and reducing sleeve, length 7 m | 452886 |
| | D 36x3.5 AS/KS/LHS 225 Ø 36 mm, for PLANEX long-reach sander, very flexible, bend-resistant suction hose, length 3.5 m | 496972 |
| | D 36/32x3.5 m AS Ø 36/32 mm, for CT26/36 AC optimal for work with masonry renovator and cleaning work, cone-shaped suction hose, length 3.5 m | 497925 |
| | D 50x2.5 m AS Ø 50 mm, with 2x rotating adapter, length 2.5 m | 452888 |
| | D 50x4 m AS Ø 50 mm, with 2x rotating adapter, length 4 m | 452890 |
| | Suction hoses temperature-resistant up to + 70°C, in a box | |
| | D 27x3.5 m Ø 27 mm, with rotating adapter and reducing sleeve, length 3.5 m | 452877 |
| | D 27x5 m Ø 27 mm, with rotating adapter and reducing sleeve, length 5 m | 452879 |
| | D 36x3.5 m Ø 36 mm, with rotating adapter and reducing sleeve, length 3.5 m | 452881 |
| | D 36x5 m Ø 36 mm, with rotating adapter and reducing sleeve, length 5 m | 452883 |
| | D 36x7 m Ø 36 mm, with rotating adapter and reducing sleeve, length 7 m | 452885 |
| | D 50x2.5 m Ø 50 mm, with 2x rotating adapter, length 2.5 m | 452887 |
| | D 50x4 m Ø 50 mm, with 2x rotating adapter, length 4 m | 452889 |
| | Meterware suction hose temperature-resistant up to + 70°C, without rotating adapter and reducing sleeve, length – m | |
| | D 27 MW-AS Ø 27 mm, antistatic, bleeder resistor (DIN IEC 312) < 10 MΩ | 452384 |
| | D 36x3.5 m AS Ø 36 mm, antistatic, bleeder resistor (DIN IEC 312) < 10 MΩ | 452385 |
| | D 50 MW-AS Ø 50 mm, antistatic, bleeder resistor (DIN IEC 312) < 10 MΩ | 452386 |
| | D 27 MW Ø 27 mm | 452383 |
| | D 36 MW Ø 36 mm | 454157 |
| | D 50 MW Ø 50 mm | 454158 |
| 18 | Suction hose, "plug it" D 27x3.5 m AS Ø 27 mm, with plug-it connection, length 3.5 m | 456746 |

| | PLANEX accessories Scope of delivery | Order no. |
|----|---|---------------|
| 19 | Locking slide VS-CT AC/SRM45 PLANEX for CT AC/CT 36 PLANEX, ensures extreme vacuum in container, the filter is cleaned even more intensely, in a box | 497926 |
| 20 | Tool holder WHR-CT 36-LHS 225 for CT 36 PLANEX, with practical carrier handle, for storing PLANEX, in a box | 495964 |

| | Hose sleeves Tubes Scope of delivery | Order no. |
|----|--|---------------|
| 21 | Rotating adapter hose sleeve for connecting to inlet nozzle of the dust extractor, exterior Ø 58 mm | |
| | D 27 DAG-AS for antistatic suction hose D 27 | 452892 |
| | D 36 DAG-AS for antistatic suction hose D 36 | 452894 |
| | D 50 DAG-AS for antistatic suction hose D 50 | 452896 |
| | D 27 DAG for suction hose D27 | 452891 |
| | D 36 DAG for suction hose D36 | 452893 |
| | D 50 DAG for suction hose D 50 | 452895 |
| 22 | Antistatic rotating angle adapter D 27 DAG/90°-AS for antistatic suction hose D 22 and D 27 of CTL MINI/CTL MIDI | 456806 |
| 23 | Antistatic reducing sleeve for suction side connections [power tool or suction nozzle] | |
| | D 22 DM-AS for suction hose D 22 | 456756 |
| | D 27 DM-AS for suction hose D27 | 487071 |
| | D 36 DM-AS for suction hose D36 | 487721 |
| | Reducing coupling RM D36/D27-AS for suction hose D 36 for reducing to D 27 | 498528 |
| 24 | Antistatic reducing sleeve D 36 DM-AS-LHS 225 for suction hose D 36, for PLANEX long-reach sander, for connection on extractor side [power tool or suction nozzle] | 495013 |
| 25 | Extraction adapter D 50/D 36 AA for connecting a D 50 suction hose to D 36 accessory | 452897 |
| 26 | Antistatic connector sleeve D 50/D 50 VM-AS for connecting suction hoses D 50/D 36/D 27, for D 27/D 36 hoses the reducing sleeve of a hose must be replaced with a rotating adapter D 27/D 36 | 493047 |
| 27 | Extension tube | |
| | D 36 VR-M 3x stainless steel, 3-piece, suitable for D 27 and D 36, length 950 mm | 452902 |
| | D 36 VR-K 3x polypropylene (PP), 3-piece, suitable for D 27 and D 36, length 950 mm | 452903 |
| | D 50 VR-M Aluminium anodised, 1-piece, suitable for D 50, length 1100 mm, in a box | 447599 |
| | D 50 VR-K 2x plastic, 2-piece, suitable for D 50, length 970 mm, in a box | 440412 |
| 28 | Hand tube D 36 HR-M suitable for D 27 and D 36, curved, stainless steel | 452900 |
| 29 | Hand tube D 36 HR-K suitable for D 27 and D 36, curved, polypropylene (PP), with air control slide for suction power adjustment | 452901 |

| | Nozzles Brushes Scope of delivery | Order no. |
|----|---|---------------|
| 30 | Crevice nozzle for CT/CTL/CTM 26/36/48 | |
| | D 36 FD-300 plastic, suitable for D 27 and D 36, length 300 mm | 452904 |
| | D 36 FD-210 plastic, suitable for D 27 and D 36, length 210 mm | 492391 |
| 31 | Crevice nozzle D 50 FD suitable for D 50, length 200 mm | 452912 |
| 32 | Suction brush | |
| | D 36 SP suitable for D 27 and D 36, Ø 70 mm | 440404 |
| | D 50 SP suitable for D 50, Ø 85 mm | 440419 |
| 33 | Universal brush nozzle D 36 UBD plastic, with brush rim and rotary hinge, suitable for D 27 and D 36 | 498527 |
| 34 | Bevel-ended nozzle D 36 SRD rubber, suitable for D 27 and D 36, length 190 mm, diameter 40 mm | 411810 |
| 35 | Upholstery nozzle D 36 PD plastic, with brush strip, suitable for D 27 and D 36, width: 120 mm | 440406 |
| 36 | Flat nozzle D 36 FDG special rubber, oil-resistant, suitable for D 27 and D 36, width: 100 mm | 440408 |

| | Nozzles Brushes | Scope of delivery | Order no. |
|----|--|--|---------------|
| 37 | Floor nozzles | | |
| | D 36 BD 370 | industrial design, aluminium, with 2 castors and 2 brush strips, suitable for D 27 and D 36, width: 370 mm | 452908 |
| | D 50 BD 450 | industrial design, aluminium, with 2 castors and 2 brush strips, suitable for D 50, width: 450 mm, in a box | 452910 |
| | D 36 BD 300 | plastic, with 2 castors and 2 brush strips, suitable for D 27 and D 36, width: 300 mm | 452907 |
| | D 50 BD 370 | plastic, with 2 castors and 2 brush strips, suitable for D 50, width: 370 mm, in a box | 452909 |
| | D 36 BD 270 | 4-piece, plastic with 3 changeable inserts (brushes, rubber lips, carpet), suitable for D 27 and D 36, width: 270 mm | 452906 |
| 38 | Carpet nozzle D 36 TD | with sliding base, switchable for textile and hard flooring, suitable for D 27 and D 36 | 452911 |
| 39 | Turbo combination suction brush D 36 TKB | for textile/hard flooring, 4 castors, 1 brush roller powered by suction air, suitable for D 27 and D 36, width: 270 mm, in a box | 450644 |
| 40 | Cleaning sets | | |
| | Cleaning set D 27/D 36 D-RS | crevice nozzle D 36 FD-210, upholstery nozzle D 36 PD, suction brush D 36 SP | 492392 |
| | Standard cleaning set D 27/D 36 S-RS | curved hand tube D 36 HR-K, 3x extension tubes D 36 VR-K, 4-piece floor nozzle D 36 BD270, crevice nozzle D 36 FD-210, upholstery nozzle D 36 PD, in a box | 492389 |
| | Professional cleaning set D 27/D 36 P-RS | curved hand tube D 36 HR-M, 3-piece stainless steel extension tube D 36 VR-M, switchable floor nozzle D 36 TD, crevice nozzle D 36 FD-210, in a box | 492390 |
| | Compact cleaning set D 27/D 36 K-RS-Plus | curved hand tube D 36 HR-K, 3x extension tubes D 36 VR-K, 4-piece floor nozzle D 36 BD270, crevice nozzle D 36 FD, upholstery nozzle D 36 PD, in a Systainer SYS 1 T-LOC | 497697 |
| | Cleaning set for tradesmen D36 HW-RS-Plus | antistatic suction hose D 36 x 3.5 m AS, curved hand tube D 36 HR-M, 3x extension tubes D 36 VR-M, carpet nozzle D 36 TD, crevice nozzle D 36 FD, upholstery nozzle D 36 PD, suction brush D 36 SP, in a SYSTAINER SYS 5 T-LOC | 497700 |
| | Cleaning set for the workshop D36 WB-RS-Plus | antistatic suction hose D36 x 3.5 m AS, curved hand tube D 36 HR-M, 3x extension tubes D 36 VR-M, floor nozzle D 36 BD370, in a SYSTAINER SYS 5 T-LOC | 497701 |
| | Universal cleaning set D36 UNI-RS-Plus | suction hose D 36 x 3.5 m, curved hand tube D 36 HR-K, 3x extension tubes D 36 VR-K, floor nozzle D 36 BD300, crevice nozzle D 36 FD, suction brush D 36 SP, upholstery nozzle D 36 PD, in a SYSTAINER SYS 5 T-LOC | 497702 |
| | Cleaning set for industrial use D 50 GS-RS | suction hose Ø 50 x 2.5 m, 2x extension tube D 50 VR-K, floor nozzle D 50 BD370, square nozzle D 50 QD, suction brush D 50 SP, crevice nozzle D 50 FD, in a box | 454770 |
| | Masonry renovation cleaning set D36 RS-M-Plus | curved hand tube D 36 HR-M, 3x extension tubes D 36 VR-M, carpet nozzle D 36 TD, crevice nozzle D 36 FD, upholstery nozzle D 36 SP, in a SYSTAINER SYS 2 T-LOC | 497698 |
| | Floor cleaning set D 36 BD 370 RS-Plus | curved hand tube D 36 HR-M, 3x extension tubes D 36 VR-M, floor nozzle D 36 BD 370, in a SYSTAINER SYS 2 T-LOC | 497699 |

| | Nozzles Brushes | Scope of delivery | Order no. |
|----|---|--|---------------|
| 41 | Nozzle and tube accessory holder | | |
| | Set ZBA-D CT26/36 | for CT/CTL/CTM 26/36, accessory holder for nozzles with crevice nozzle D 36 FD-210, upholstery nozzle D 36 PD, suction brush D 36 SP | 496369 |
| | ZBA-D CT26/36 | for CT/CTL/CTM 26/36, for storing 1 floor nozzle D27/36 and up to 4 nozzles | 496373 |
| | ZBA-D/R CT26/36/48 | for CT/CTL/CTM 26/36/48, for storing curved hand tube, 3-piece extension tube, floor nozzle and up to four additional nozzles | 496370 |

| | Filter | Scope of delivery | Order no. |
|----|--|--|---------------|
| 42 | Main filter | in a box | |
| | HF-CT-MINI/MIDI | for CT/CTL MINI, CT/CTL MIDI, pack of 1 | 456790 |
| | HF-CT 26/36/48 | for CT/CTL/CTM 26/36/48, pack of 1, not suitable for CT with AUTOCLEAN | 496170 |
| | High-performance HF-CT 26/36/48 | for CT AC, optimised cleaning of main filter | 496172 |
| | HEPA HF-CT 26/36 | for CT/CTL/CTM 26/36/48, satisfies HEPA class 13, pack of 1 | 496171 |
| | HF-CTH 26/48 | for CTH 26/48, pack of 1 | 498331 |
| 43 | Wet filter | | |
| | NF-CT MINI/MIDI | for CT/CTL MINI, CT/CTL MIDI, pack of 1 | 456805 |
| | NF-CT 26/36/48 | for CT/CTL/CTM 26/36/48, pack of 1 | 496169 |

| | Filter bags | Scope of delivery | Order no. |
|----|---|---|---------------|
| 44 | SELFCLEAN filter bag | optimum usage of the filter bag space and constantly high suction power thanks to SELFCLEAN filter bag, pack of 5 in a box | |
| | SC FIS-CT MINI/5 | for CT/CTL MINI | 498410 |
| | SC FIS-CT MIDI/5 | for CT/CTL MIDI | 498411 |
| | SC FIS-CT 26/5 | for CT/CTL/CTM 26 | 496187 |
| | SC FIS-CT 36/5 | for CT/CTL/CTM 36 | 496186 |
| | SC FIS-CT 48/5 | for CT/CTL/CTM 48 | 497539 |
| 45 | Double-layered safety filter bag | very flexible non-woven filter bag and double-layered PE material, satisfies requirements of dust class H, pack of 3 in a box | |
| | FIS-CTH 26/3 | for CTH 26 | 497541 |
| 46 | Longlife filter bag | sturdy, longlife, triple-layered non-woven polyester, can only be used for extracting non-hazardous dust, pack of 1 in a box | |
| | Longlife FIS-CT 26 | for CT/CTL/CTM 26 | 496120 |
| | Longlife FIS-CT 36 | for CT/CTL/CTM 36 | 496121 |
| | Longlife FIS-CT 48 | for CT/CTL/CTM 48 | 498506 |
| 47 | Disposal bag | Pack of 5 in a box | |
| | ENS-CT 26 AC/5 | for CT/CTL/CTM 26 AC | 496216 |
| | ENS-CT 36 AC/5 | for CT/CTL/CTM 36 AC | 496215 |
| | ENS-CT 48 AC/5 | for CT/CTL/CTM 48 AC | 497540 |

FESTOOL

Tools for the toughest demands

TTS Tooltechnic Systems AG & Co. KG

Wertstraße 20
D-73240 Wendlingen

represented by:

TTS Tooltechnic Systems GB Ltd

Saxham Business Park
Saxham
Bury St Edmunds
Suffolk
IP28 6RX
Great Britain
Phone: +44 (0) 1284 760791
Fax: +44 (0) 1284 702156
E-mail: info@festool.co.uk

in Ireland:

Registered office address:
TTS Tooltechnic Systems Ltd
c/o McCann Duffy Cleary
E12 Calmount Park
Ballymount
Dublin 12
Place of registration: Ireland
Company No.: 133724

Phone +353 1 8642240
Fax +353 1 8642247
E-Mail sales@festool.ie
Web www.festool.ie

www.festool.co.uk



Our tools live up to the claim "Made in Germany" –
Tools for the toughest demands.
Visit www.festool.co.uk for more information



Festool service: Original from Festool with extended
warranty of 3 years and comprehensive services.
Visit www.festool.co.uk for more information



Old tool return, recycling, waste prevention.
For a cleaner environment.
Visit www.festool.co.uk for more information

Dealer

Festool
Dust extraction
Valid from 04/2011

Order no. 61520



Errors and omissions excepted. Products may differ from those pictured.
Created for TTS Tooltechnic Systems AG & Co. KG,
73240 Wendlingen, 04/2011