

Milwaukee®

HEAVY-DUTY ELECTRIC TOOLS

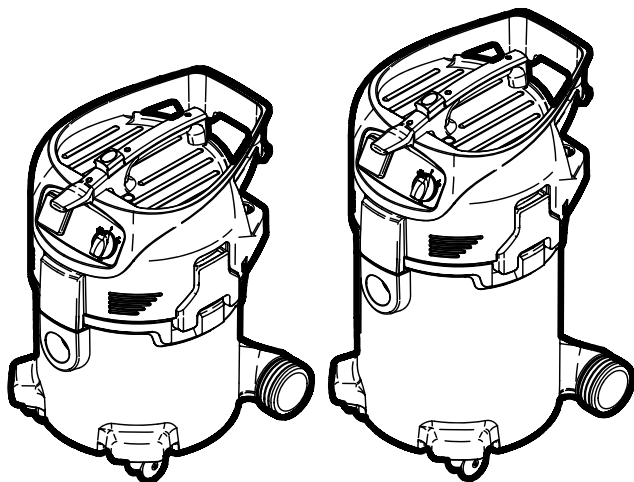

AS 300 ELCP AS 500 ELCP



Original instructions
Originalbetriebsanleitung
Notice originale
Istruzioni originali
Manual original
Manual original
Oorspronkelijke
gebruiksaanwijzing
Original brugsanvisning
Original bruksanvisning
Bruksanvisning i original
Alkuperäiset ohjeet
Πρωτότυπο οδηγιών χρήσης
Orijinal işletme talimatı
Původním návodem k používání

Pôvodný návod na použitie
Instrukcja oryginalną
Eredeti használati utasítás
Izvirna navodila
Originalne pogonske upute
Instrukcijām oriģinālvalodā
Originali instrukcija
Algupärane kasutusjuhend
Оригинальное руководство по
эксплуатации
Оригинално ръководство за
експлоатация
Instrucțiuni de folosire originale
Оригинален прирачник за работа
原始的指南

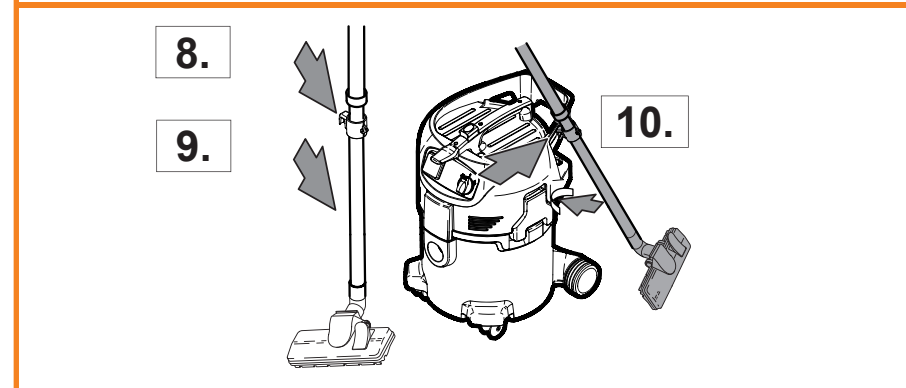
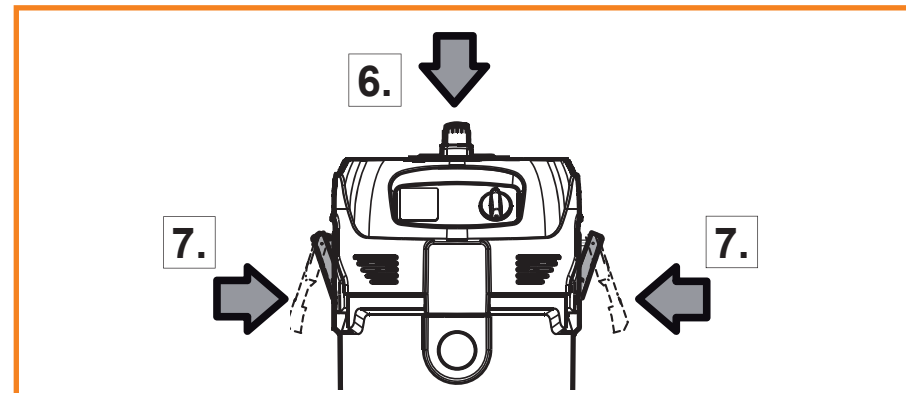
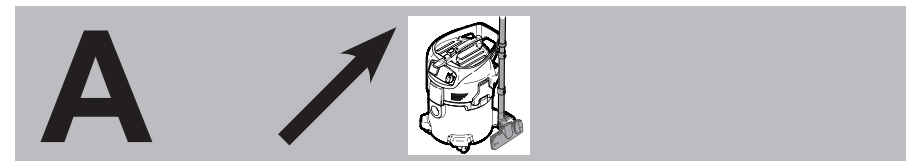
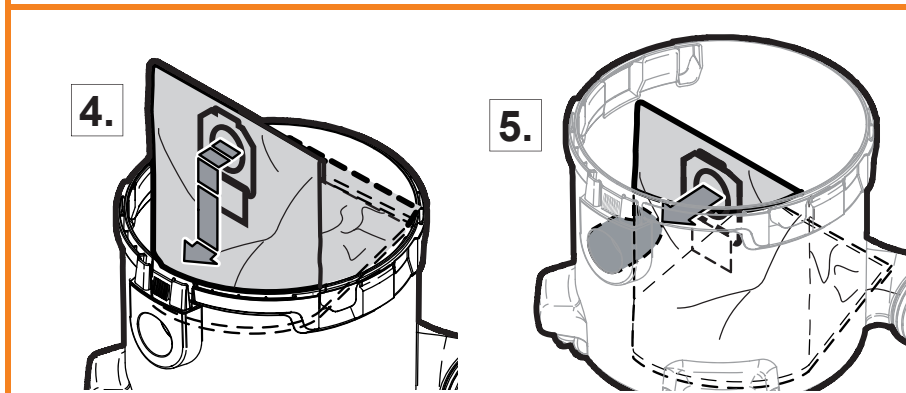
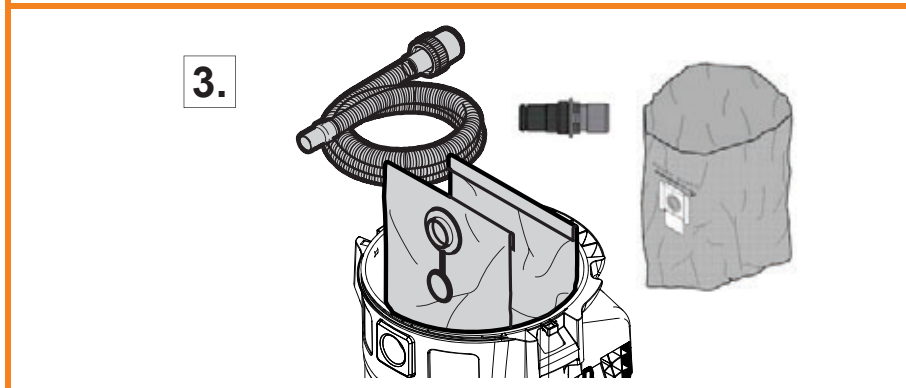
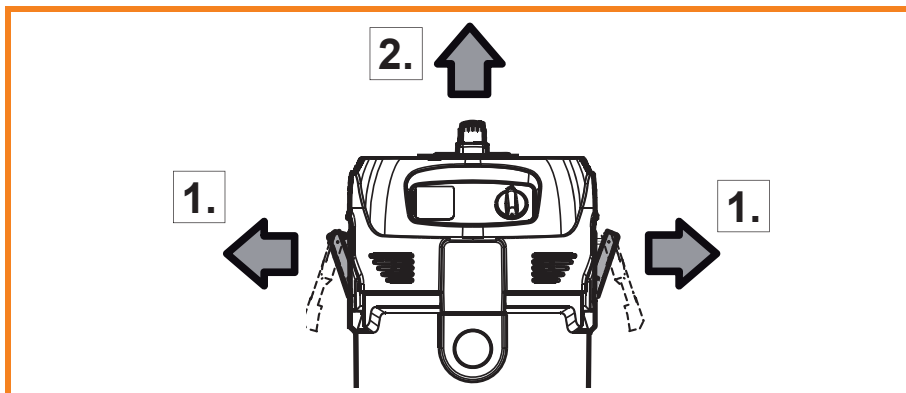
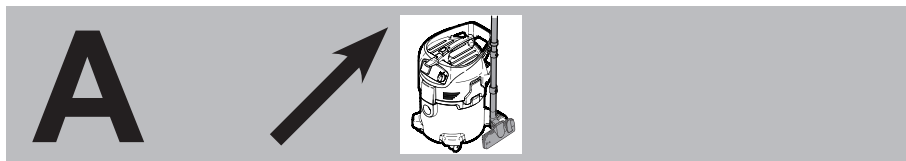

Zubehör - Im Lieferumfang nicht enthalten, empfehle-
ne Ergänzung aus dem Zubehörprogramm.
Accessory - Not included in standard equipment,
available as an accessory.
Accessoires - Ces pièces ne font pas partie de la
livraison. Il s'agit là de compléments recommandés
pour votre machine et énumérés dans le catalogue
des accessoires.
Accessorio - Non incluso nella dotazione standard,
disponibile a parte come accessorio.
Accessorio - No incluido en el equipo estándar,
disponible en la gama de accesorios.
Accessório - Não incluído no equipamento normal,
disponível como acessório.
Tilbehør - Wordt niet meegeleverd. Is apart lever-
baar. Zie hiervoor het toebehørensprogramma.
Tilbehør - Ikke inkluderet i leveringsomfanget, kab
købes som tilbehør.
Tilbehør - ingår ej i leveransen, anbefalt komplette-
ring fra tilbehørsprogrammet.
Tilbehør - ingår ej i leveransomfanget, erhåltes som
tilbehør.
Lisälaitte - Ei sisälly vakiovarustukseen, saatavana
lisätarvikkeena.
Εξαρτήματα - Δεν περιλαμβάνονται στα υλικά
παράδοσης, συνιστάται η προμήθεια από το

πρόγραμμα εξαρτημάτων.
Aksesuar - Teslimat kapsamında değildir, önerilen
tamamlayıcı aksesuar programında.
Príslušenství není součástí dodávky, viz program
příslušenství.
Prilučsenstvo - nie je súčasťou štandardnej výbavy,
odporúčané doplnenie z programu príslušenstva.
Wyposażenie dodatkowe dostępne osobno.
Azokat a tartozékokat, amelyek gyárilag nincsenek a
készülékhez mellékelve, külön lehet megrendelni.
Oprema - ni vsebovana v obsegu dobave,
priporočeno dopnilno iz programa opreme.
Oprema - u opsegu isporuke nije sadržana,
preporučena dopuna iz promograma opreme.
Piederumi - standartaprīkojumā neietvertās, bet
ieteicamās papildus komplektācijas detaļas no
piederumu programmas.
Priedas - neįeina į liekimo komplektaciją, rekomendu-
ojamas papildomas iš priedų asortimento.
Tarvikud - ei kuulu tärne komplekti, soovitatav täiendus
on saadaval tarvikute programmis.
Дополнитель - В стандартную комплектацию не
входит, поставляется в качестве дополнительной
принадлежности.
Аксесори - Не се съдържат в обема на



B



1.

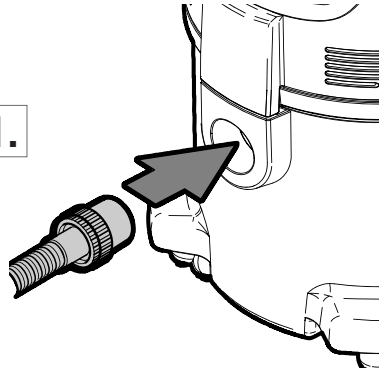

2.

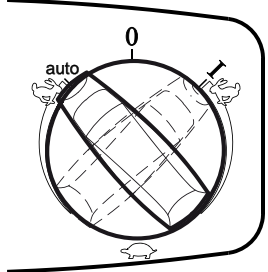
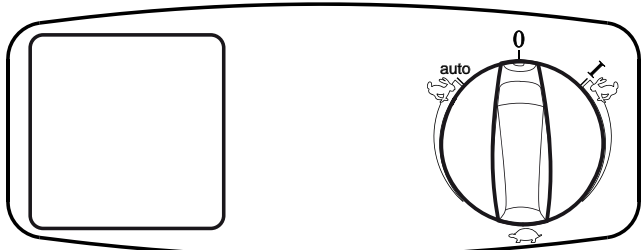
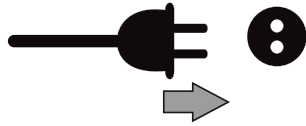

0 = ○
 I = ●
 auto =

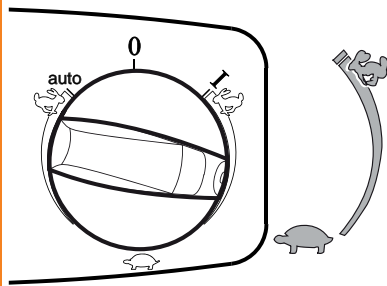

B

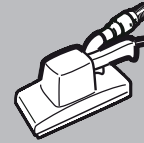

1.

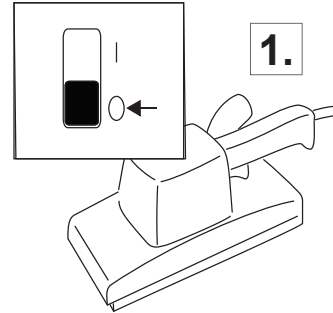

2.

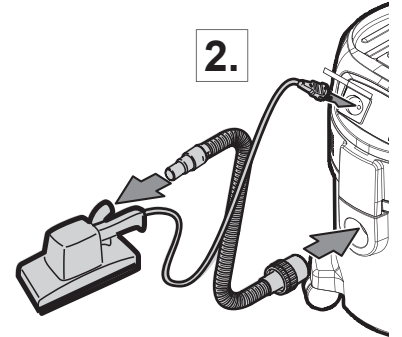

3.

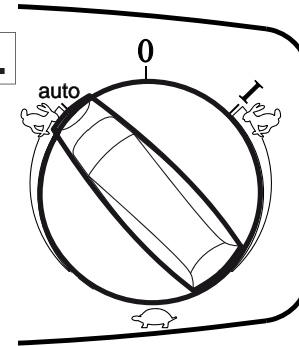

4.

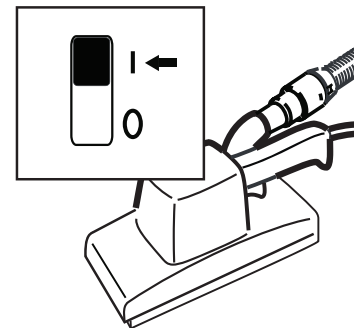

B

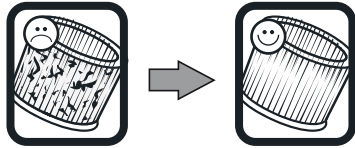

Clear-Press
Filter Cleaning System

1. Turn dial to 'I' (hand icon)

2. Plug power cord

3. Press start button (3x)

C

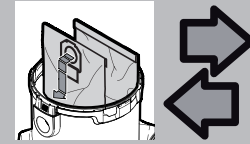

1. Turn dial to '0' (hand icon)

2. Plug power cord

3. Push front panel outwards

4. Push front panel upwards

5. Insert filter

6. Push front panel downwards

7. Push front panel downwards

8. Push front panel inwards

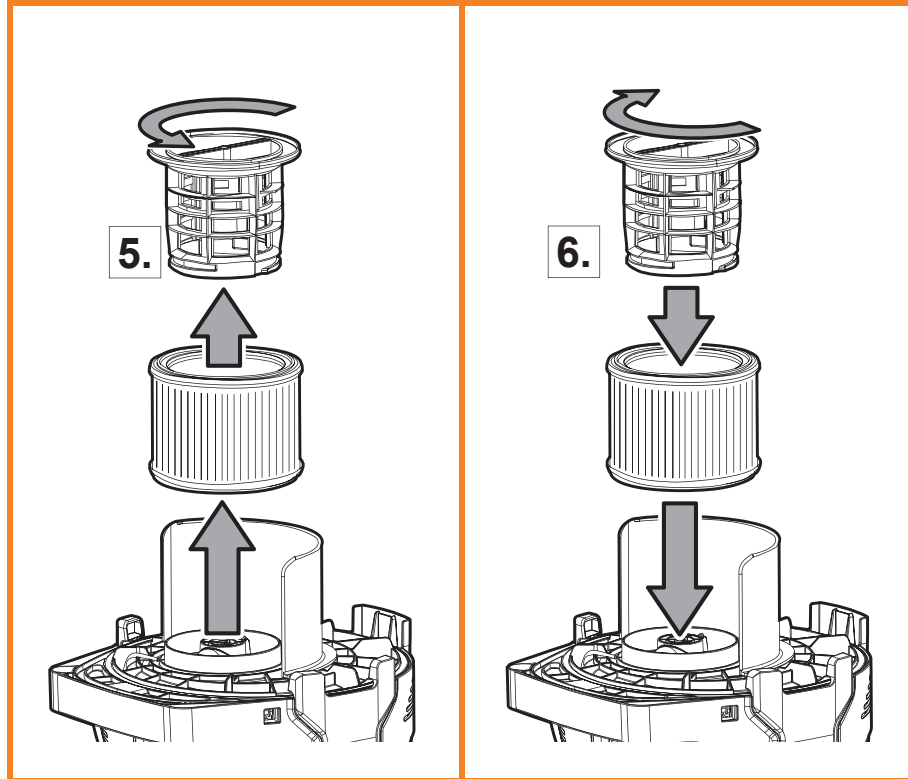
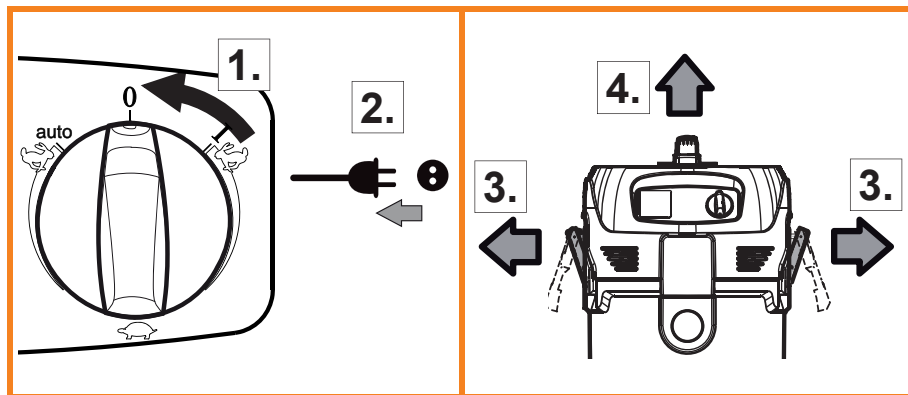
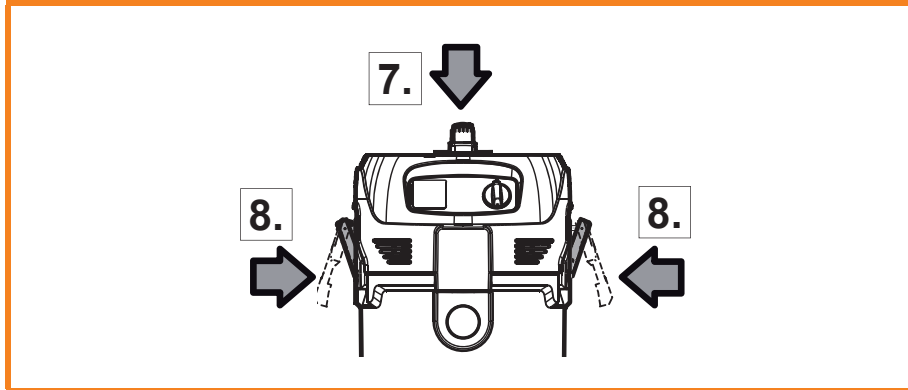
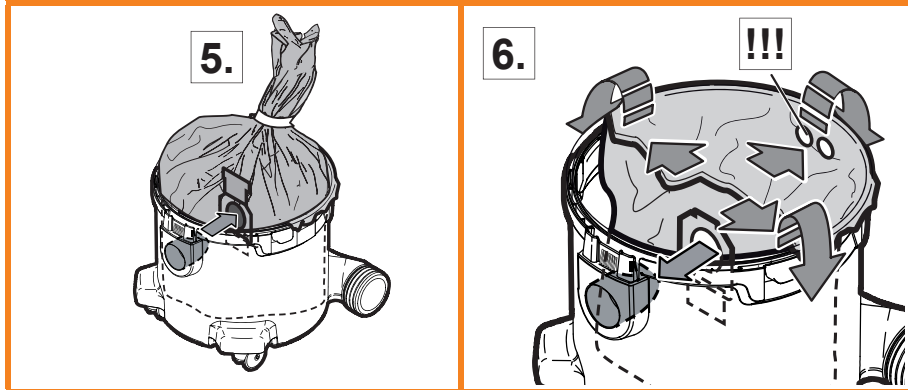
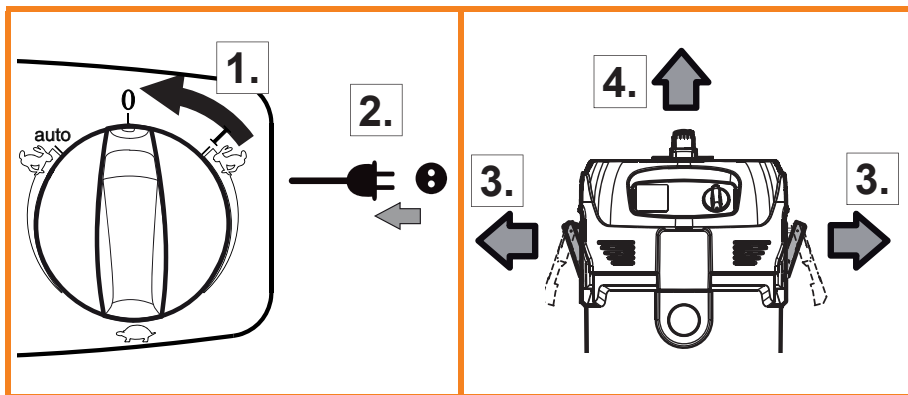
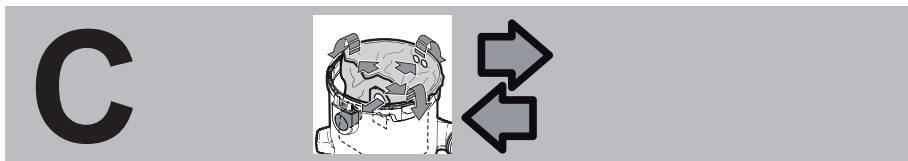

D

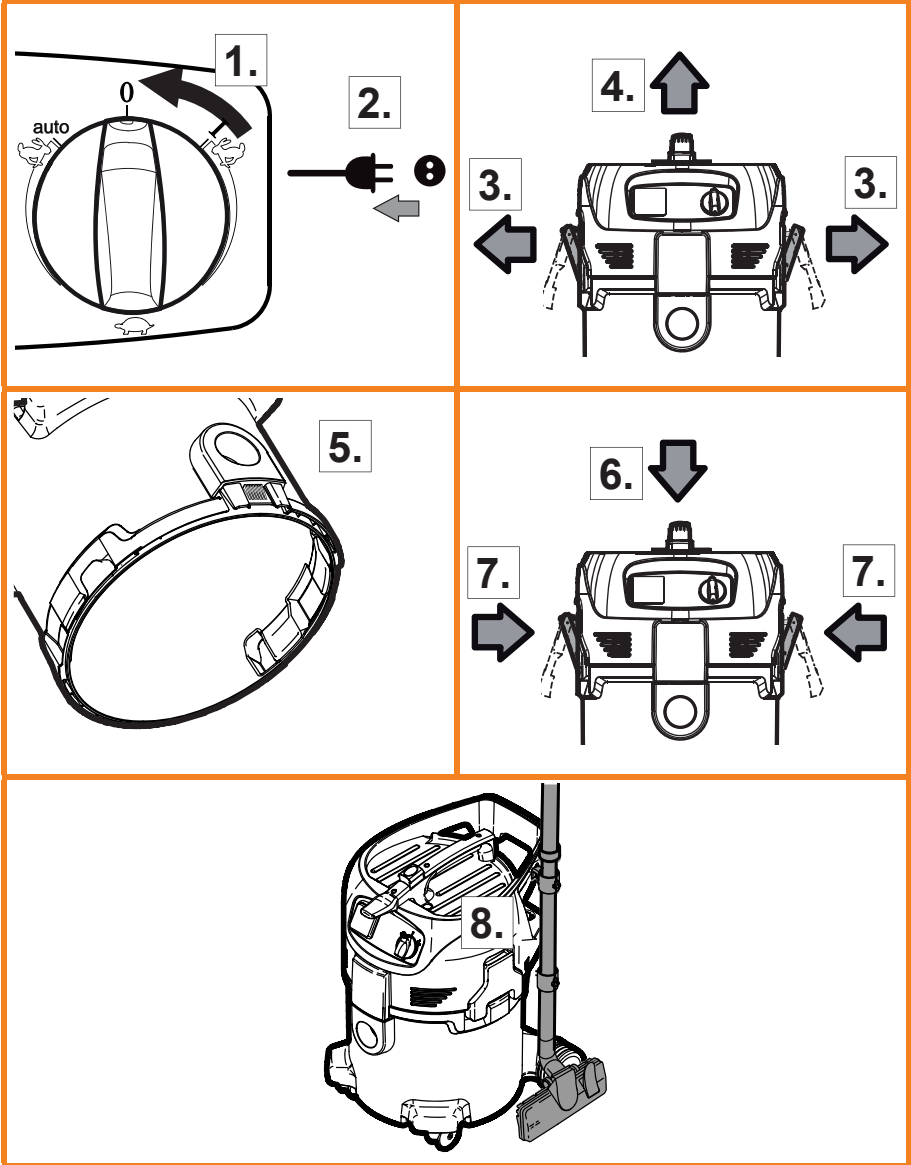
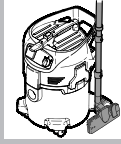

This document



CAUTION! Prior to using the appliance for the first time, be sure to read this document through and keep it ready to hand.

Further support

For further queries, please contact the Milwaukee service representative responsible for your country.

Important safety instructions

Symbols used to mark instructions

	DANGER
	Danger that leads directly to serious or irreversible injuries, or even death.
	WARNING
	Danger that can lead to serious injuries or even death.
	CAUTION
	Danger that can lead to minor injuries and damage.

Meaning of the symbols

	Danger
	Please read the instructions carefully before starting the machine.

The instructions for actions are subdivided into 7 sections, which are represented by symbols.

	A Before starting
	B Control / Operation
	B Connecting electrical appliances

	C Replacement of filter bag
	C Replacement of disposal bag
	C Replacement of filter element
	D After finishing work

The appliance must

- only be used by persons, who have been instructed in its correct usage and explicitly commissioned with the task of operating it
- only be operated under supervision
- not be used by children

1. Do not use any unsafe work techniques.
2. Never use the vacuum cleaner without a filter.
3. Switch off the appliance and disconnect the mains plug in the following situations:
 - Prior to cleaning and servicing
 - Prior to replacing components
 - Prior to changing over the appliance
 - If foam develops or liquid emerges

When dust removers are used, the rate at which air is exchanged in the room must be adequate if the exhaust air from the vacuum cleaner is blown into the room (please observe regulations valid in your country).

Besides the operating instructions and the binding accident prevention regulations valid in the country of use, observe recognised regulations for safety and proper use.

The plug socket on the appliance may be used only for the purposes defined in the usage instructions.

CAUTION! This device must not be used or stored outdoors in wet conditions.

CAUTION! The device contains noxious dust. Emptying and maintenance procedures, including the removal of dust collectors, may only be carried out by trained personnel

wearing appropriate protective gear. Do not operate without complete filtration system. Before using the device, users must be given information on the use of the device and on how to handle and dispose of the hazardous substances for which the device is intended to be used.

When carrying out maintenance and repair work it is necessary to dispose of any contaminated objects which cannot be adequately cleaned. Such objects must be placed in impermeable bags in compliance with the relevant regulations for the disposal of such refuse.

Purpose and intended use

The appliance is suitable for picking up dry, non-flammable dust and liquids.



The vacuum cleaners described in this operating manual are suitable for

- for separation of dust with an exposure limit of greater than 1 mg/m³, (dust class L).
- commercial use, e.g. in hotels, schools, hospitals, factories, shops, offices and rental businesses.

Any other use is considered as improper use. The manufacturer accepts no liability for any damage resulting from such use. The risk for such use is borne solely by the user. Proper use also includes proper operation, servicing and repairs as specified by the manufacturer. See operating instructions.

Transport

1. Before transporting the dirt tank, close all the locks.
2. Do not tilt the cleaner if there is liquid in the dirt tank.

Storage

1. Store the appliance in a dry place, protected from frost.

Electrical connection

1. It is recommended that the vacuum cleaner should be connected via a residual

current circuit breaker.

2. Arrange the electrical parts (sockets, plugs and couplings) and lay down the extension lead so that the protection class is maintained.
3. Connectors and couplings of power supply cords and extension leads must be watertight.

Extension lead

1. As an extension lead, only use the version specified by the manufacturer or one of a higher quality. See operating instructions.
2. When using an extension lead, check the minimum cross-sections of the cable:

Cable length	Cross section	
	< 16 A	< 25 A
up to 20 m	1,5 mm ² / AWG 14	2,5 mm ² / AWG 12
20 to 50 m	2,5 mm ² / AWG 12	4,0 mm ² / AWG 10

Maintenance, cleaning and repair

A dust test must be performed at least once every year by Milwaukee service or a trained person. This test includes, for example, whether there is damage to the filter, the vacuum cleaner is sealed to the air and the control equipment works properly.

During maintenance and cleaning, handle the vacuum cleaner in such a manner that there is no danger for maintenance staff or other persons.

In the maintenance area

- use filtered compulsory ventilation
- wear protective clothing
- clean the maintenance area so that no harmful substances get into the surroundings

Risks

Electrical components

	DANGER
	<p>Electric shock due to faulty mains connecting lead.</p> <p>Touching a faulty mains connecting lead can result in serious or even fatal injuries.</p> <ol style="list-style-type: none"> 1. Do not damage the mains power lead (e.g. by driving over it, pulling or crushing it). 2. Regularly check whether the power cord is damaged or shows signs of ageing. 3. Have the faulty mains connecting lead replaced by your Milwaukee service representative or a qualified electrician prior to using the appliance again.

	DANGER
	<p>The upper section of the vacuum cleaner contains live components.</p> <p>Contact with live components leads to serious or even fatal injuries.</p> <ol style="list-style-type: none"> 1. Never spray water on to the upper section of the vacuum cleaner.

	CAUTION
	<p>Appliance socket.</p> <p>The appliance socket is only designed for the purposes defined in the operating instructions. The connection of different appliances can result in damage.</p> <ol style="list-style-type: none"> 1. Prior to plugging in an appliance, always switch off the vacuum cleaner and the appliance that is to be connected. 2. Read the operating instructions to the appliance to be connected and observe the safety notes contained in these.

	CAUTION
	<p>Damage due to unsuitable mains voltage.</p> <p>The appliance can be damaged as a result of being connected to an unsuitable mains voltage.</p> <ol style="list-style-type: none"> 1. Ensure that the voltage shown on the rating plate corresponds to the voltage of the local mains power supply.

Picking up liquids

	CAUTION
	<p>Picking up liquids.</p> <p>Do not pick up flammable liquids.</p> <ol style="list-style-type: none"> 1. Before liquids are picked up, always remove the filter bag/disposal bag. 2. Regularly clean the built in float and level indicator hose to limit the water level and check that they are not damaged. 3. The use of a separate filter element or filter screen is recommended. 4. If foam appears, stop work immediately and empty the tank.

Hazardous materials

	WARNING
	<p>Hazardous materials.</p> <p>Vacuuming up hazardous materials can lead to serious or even fatal injuries</p> <ol style="list-style-type: none"> 1. The following materials must not be picked up by the vacuum cleaner: <ul style="list-style-type: none"> - hazardous dust - hot materials (burning cigarettes, hot ash, etc.) - flammable, explosive, aggressive liquids (e.g. petrol, solvents, acids, alkalis, etc.) - flammable, explosive dust (e.g. magnesium or aluminium dust, etc.)

Emptying dirt tank

CAUTION	
	<p>Picking up environmentally hazardous materials.</p> <p>Materials picked up can present a hazard to the environment.</p> <p>1. Dispose of the dirt in accordance with legal regulations.</p>

Spare parts and accessories

CAUTION	
	<p>Spare parts and accessories.</p> <p>The use of non-genuine spare parts and accessories can impair the safety of the appliance.</p> <p>1. Only use spare parts and accessories from Milwaukee.</p> <p>2. Use only the brushes supplied with the vacuum cleaner or specified in the operating manual.</p>

Recycling the cleaner

Make the old cleaner unusable immediately.

1. Unplug the cleaner.
2. Cut the power cord.
3. Do not discard of electrical appliances with household waste.



As specified in European Directive 2002/96/EC on old electrical and electronic appliances, used electrical goods must be collected separately and recycled ecologically. Contact your local authorities or your nearest dealer for further information.

Warranty

Our general conditions of business are applicable with regard to the guarantee. Unauthorised modifications to the appliance, the use of incorrect brushes in addition to using the appliance in a way other than for the intended purpose exempt the manufacturer from any liability for the resulting damage.

Tests and approvals

Electrical tests must be performed in accordance with the provisions of safety regulations (BGV A3) and to DIN VDE 0701 Part 1 and

Part 3. In accordance with DIN VDE 0702 these tests must be performed at regular intervals and after repairs or modifications.

	EC conformity declaration
Milwaukee Electric Tool	
Product:	Vacuum cleaner for wet and dry operation
Model:	AS 300 ELCP, AS 500 ELCP
Description:	110 V~, 50/60 Hz 230-240 V~, 50/60 Hz
The design of the machine complies with the following regulations:	EC Low Voltage Directive 2006/95/EC EC EMC Directive 2004/108/EC EC Directive 2006/42/EC
Harmonized standards:	EN ISO 12100-1, EN ISO 12100-2 EN 60335-1, EN 60335-2-69 EN 55014-1, EN 55014-2, EN 61000-3-2, EN 61000-3-3, EN 50366
National standards and technical specifications:	DIN EN 60335-1 DIN EN 60335-2-69
Winnenden, 06.05.2009	
Rainer Kumpf Manager Product Development	

Optional accessories

Description	Order No.
Filter Element	4932 352304
Fleece filter bag (5 pcs.)	4932 352307
Disposal bag (5 pcs.)	4932 352309

Technical data

		AS 300 ELCP			
		EU	CH	GB 230/240 V	GB 110 V
Voltage	V	230		230/240	110
Mains frequency	Hz	50/60			
Fuse	A	16	10	13	25
Power consumption _{IEC}	W	1200			1000
Connected load for appliance socket	W	2400	1100	1800	1750
Total connected load	W	3600	2300	3000	2750
Air flow rate	m ³ /h	222			192
Vacuum	hPa	250			230
Sound pressure level at a distance of 1 m, EN 60704-1	dB(A)	62			
Sound level	dB(A)	59			
Power cord: Length	m	8,2			
Power cord: Type		H05RR-F 3G1,5	H05RR-F 3G1,5	H05RR-F 3G1,5	H07BQ-F 3G2,5
Protection class		I			
Type of protection		IP X4			
Radio interference level		EN 55014-1			
Tank volume	l	30			
Width	mm	380			
Depth	mm	450			
Height	mm	595			
Weight	kg	10			

		AS 500 ELCP			
		EU	CH	GB 230/240 V	GB 110 V
Voltage	V	230		230/240	110
Mains frequency	Hz	50/60			
Fuse	A	16	10	13	25
Power consumption _{IEC}	W	1200			1000
Connected load for appliance socket	W	2400	1100	1800	1750
Total connected load	W	3600	2300	3000	2750
Air flow rate	m ³ /h	222			192
Vacuum	hPa	250			230
Sound pressure level at a distance of 1 m, EN 60704-1	dB(A)	62			
Sound level	dB(A)	59			
Power cord: Length	m	8,2			
Power cord: Type		H05RR-F 3G1,5	H05RR-F 3G1,5	H05RR-F 3G1,5	H07BQ-F 3G2,5
Protection class		I			
Type of protection		IP X4			
Radio interference level		EN 55014-1			
Tank volume	l	50			
Width	mm	380			
Depth	mm	450			
Height	mm	750			
Weight	kg	11			